

HOLIDAY. ICH-082

Traditional



SPECIFICATIONS

SQ. FT.	2313
BEDROOMS:	2
BATHROOMS:	2
LEVELS:	1.5

OPTIONAL FEATURES

- ☒ Green Certification
- ☒ Energy Star

Upgrades Included: Ceramic tile throughout, corian quartz kitchen countertop, stairs with oak treads and white risers, painted cabinets, ceramic tile shower walls in master bath.

Onsite by Others: Appliances not included, porches onsite by others

FIRST FLOOR

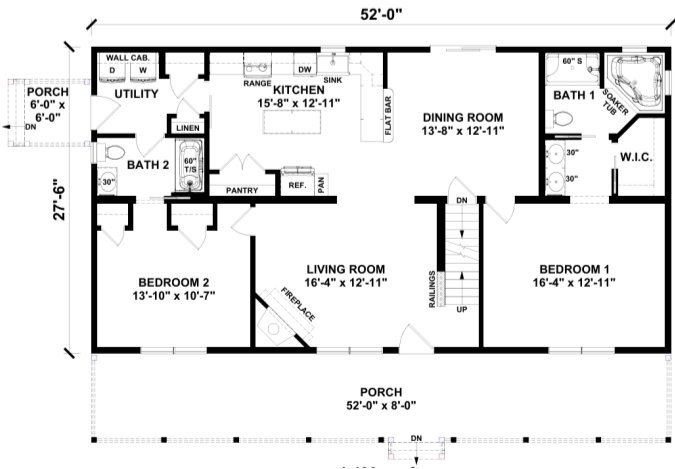

SUGGESTED SECOND FLOOR

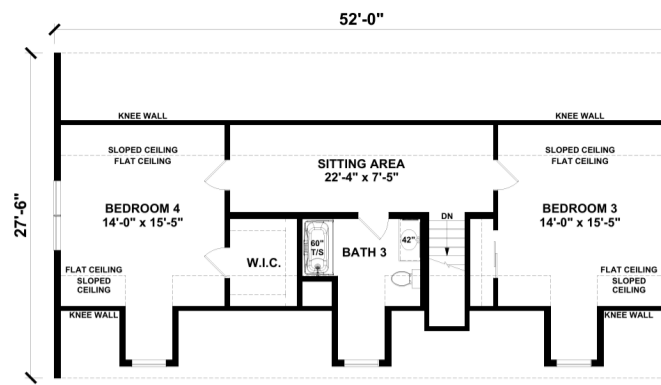

YOUR
NEW HOME
CONSULTANT

Hi, I'm , your personal Modular Home Consultant

I would be happy to help you with any questions you may have. You can contact me on my direct number at or email me at .