



SPECIFICATIONS

SQ. FT.	1725
BEDROOMS:	3
BATHROOMS:	2
LEVELS:	1

OPTIONAL FEATURES

- ☒ Green Certification
- ☒ Energy Star

As you enter the Deland home plan, you are greeted by a spacious and open floor plan that seamlessly connects the main living areas. The living room is centrally located, providing a comfortable and inviting space for relaxation and entertainment. Adjacent to the living room is the dining area, which offers ample space for family meals and gatherings.

The kitchen is a highlight of the this plan, featuring modern appliances, abundant counter space, and a large island with additional seating. This well-designed kitchen is perfect for both casual dining and meal preparation, making it the heart of the home.

Upgrades Included: Granite kitchen countertop, garden tub/shower in master bath, natural cabinets, LVP flooring in kitchen, dining room, family room, utility room, and mud room, sheet vinyl in bedrooms and bathrooms.

Onsite by Others: appliances not included, porch and exterior stairs onsite by others.

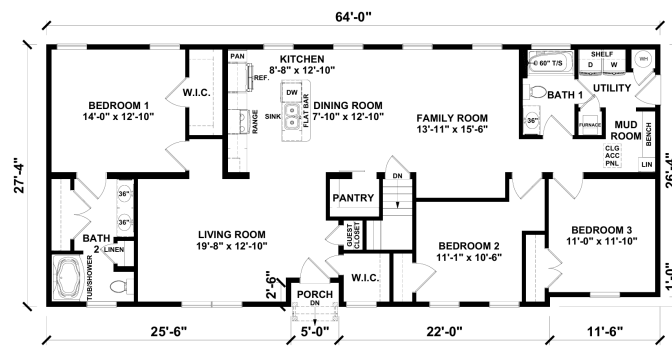

YOUR  
NEW HOME  
CONSULTANT

Hi, I'm , your personal Modular Home Consultant

I would be happy to help you with any questions you may have. You can contact me on my direct number at or email me at .