

CRESTVIEW . ICH-066

Traditional



SPECIFICATIONS

SQ. FT.	1265
BEDROOMS:	3
BATHROOMS:	2
LEVELS:	1

OPTIONAL FEATURES

- Green Certification
- Energy Star

The Crestview home plan boasts modern elegance. Within its charming exterior lies a spacious and inviting interior, carefully designed to accommodate the needs of modern living. With an open concept layout, the Crestview seamlessly blends the kitchen, dining, and living areas, creating an ideal space for both entertaining guests and everyday family life. Large windows flood the interior with natural light, enhancing the sense of openness and connection to the surrounding landscape.

The master suite provides a peaceful retreat, complete with a luxurious ensuite bathroom and ample closet space. Two additional bedrooms offer versatility, whether used as a home office, guest room, or children's quarters. A well-appointed second bathroom ensures convenience for all occupants.

This home plan also features thoughtful touches such as a mudroom entry, perfect for storing outdoor gear, and a covered porch, ideal for enjoying outdoor meals or simply unwinding after a long day.

Designed with quality craftsmanship and modern amenities, the Crestview offers a harmonious blend of style and functionality, making it the perfect place to call home.

* Upgrades Included: oak cabinets, granite countertop in kitchen, LVP flooring throughout, carpet in bedrooms.
Onsite by Others: Appliances, porch stairs and railings not included.

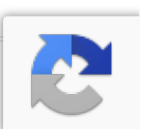

FIRST FLOOR

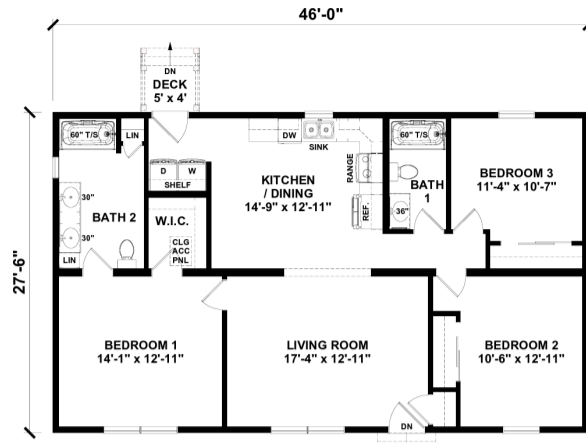

**YOUR
NEW HOME
CONSULTANT**



Hi, I'm , your personal Modular Home Consultant

I would be happy to help you with any questions you may have. You can contact me on my direct number at or email me at .

