

# DANIA . ICH-059

Traditional



## SPECIFICATIONS

|            |      |
|------------|------|
| SQ. FT.    | 1465 |
| BEDROOMS:  | 3    |
| BATHROOMS: | 2    |
| LEVELS:    | 1    |

## OPTIONAL FEATURES

- Green Certification
- Energy Star

The Dania epitomizes charming suburban living with its thoughtful layout and stylish details. Spanning 1,524 square feet across a single story, This home is designed to maximize space and comfort for modern families. Upon entry, the Dania welcomes you with a spacious foyer that opens into a bright and airy great room, ideal for gatherings and daily living. The adjacent dining area and kitchen are seamlessly integrated, featuring contemporary Stainless steel Appliances, cabinetry, and sleek countertops that cater to both culinary enthusiasts and casual family meals.

Upgrades Included: Vinyl and Carpet throughout, Pressure Treated Porch with Columns, Stainless Steel Appliances

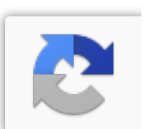

FIRST FLOOR

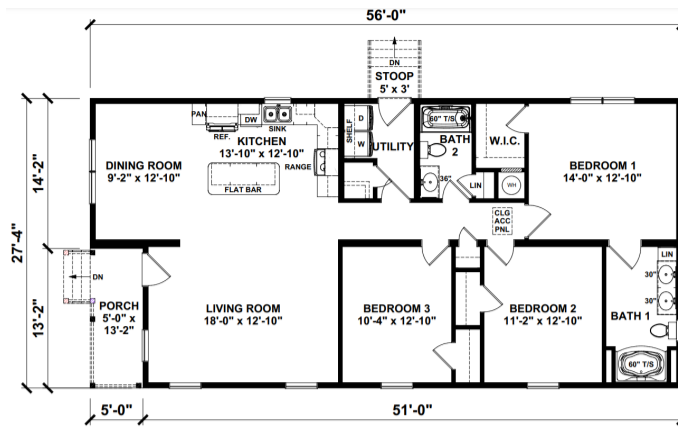

YOUR  
NEW HOME  
CONSULTANT



Hi, I'm , your personal Modular Home Consultant

I would be happy to help you with any questions you may have. You can contact me on my direct number at or email me at .

