

# CASCADE. SII-001

Container



## SPECIFICATIONS

SQ. FT.	320
BEDROOMS:	1
BATHROOMS:	1
LEVELS:	1

## OPTIONAL FEATURES

- Green Certification
- Energy Star

The Cascade - SII-001 is a cutting-edge and innovative container home that seamlessly combines modern design with sustainability and adaptability. This unique dwelling is a prime example of contemporary architecture that repurposes shipping containers to create stylish and eco-friendly living spaces. Despite its compact footprint, this container home maximizes space utilization. The interior is thoughtfully designed to optimize functionality while maintaining a comfortable living environment. Cascade-SII-001 can be tailored to suit various needs. The Cascade-SII-001 container home is a testament to the possibilities of sustainable and innovative housing solutions. This container home offers an eco-friendly and aesthetically pleasing option that stands out for its adaptability and style.

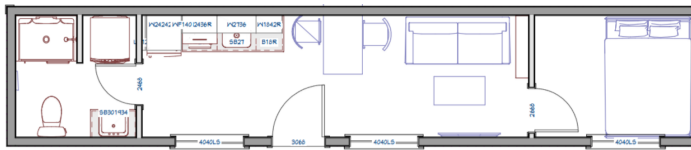

YOUR  
NEW HOME  
CONSULTANT



**Hi, I'm Chris Runyan, your personal Modular Home Consultant**

I would be happy to help you with any questions you may have. You can contact me on my direct number at **(877) 419-9858** or email me at

**[chris.runyan@impresamodular.com](mailto:chris.runyan@impresamodular.com)**.