

# KINSLEY . CVL-015

Traditional



## SPECIFICATIONS

|            |      |
|------------|------|
| SQ. FT.    | 2969 |
| BEDROOMS:  | 5    |
| BATHROOMS: | 3.0  |
| LEVELS:    | 1.5  |

## OPTIONAL FEATURES

- Green Certification
- Energy Star

The Kinsley is a charming and spacious home plan. The home boasts a total living space of 2,969 square feet and features five bedrooms, three bathrooms, and a two-car garage.

Upon entering the home, you are greeted by a foyer that leads into an open-concept living area that combines the kitchen, dining room, and living room. The kitchen is equipped with modern appliances, plenty of counter space, and a large island, making it the perfect space for entertaining guests.

The master bedroom is located on the opposite side of the main level away from two bedrooms, providing maximum privacy. The master suite includes a walk-in closet and a spacious ensuite bathroom with a double vanity, and a separate shower.

The final 2 bedrooms are located on the second level. There is a sitting area and a full bath.

The Kinsley also includes a laundry room conveniently located near the bedrooms, making laundry day a breeze. Additionally, the home features a covered front porch providing ample outdoor living space.

Overall, the Kinsley offers a comfortable and stylish living space that is perfect for families or anyone looking for a spacious and modern home. With its many amenities and convenient layout, it's easy to see why the Kinsley is a popular choice among home buyers.

## FIRST FLOOR



**SUGGESTED SECOND FLOOR**



**OPTIONAL BASEMENT LAYOUT**

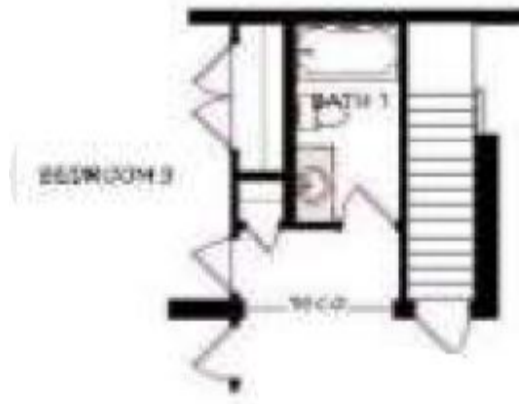

**YOUR  
NEW HOME  
CONSULTANT**



**Hi, I'm , your personal Modular Home Consultant**

I would be happy to help you with any questions you may have. You can contact me on my direct number at or email me at .

