

PAISLEY II . CVL-014

Traditional



SPECIFICATIONS

SQ. FT.	1441
BEDROOMS:	3
BATHROOMS:	2.5
LEVELS:	1.5

OPTIONAL FEATURES

- Green Certification
- Energy Star

The Paisley II is a stylish and modern home plan. This 1.5-story home features 3 bedrooms and 2.5 bathrooms with a total living area of 1441 square feet. The exterior of the home is designed with a blend of modern and traditional elements. The front porch leads into a welcoming living room/kitchen combination. The kitchen features a large center island and ample counter space. The main floor also includes a half bath and the master bedroom and bath featuring a tub and shower combination. Upstairs you will find 2 other bedrooms and a shared full bathroom. Overall, the Paisley II is a spacious and functional home that is perfect for modern families.

FIRST FLOOR



SECOND FLOOR



OPTIONAL BASEMENT LAYOUT

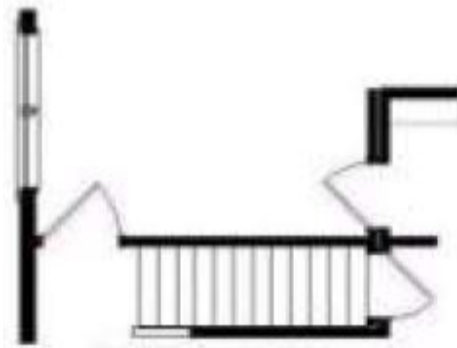

**YOUR
NEW HOME
CONSULTANT**



Hi, I'm , your personal Modular Home Consultant

I would be happy to help you with any questions you may have. You can contact me on my direct number at or email me at .

