

BEECHDALE. SCS-022

Traditional



SPECIFICATIONS

SQ. FT.	1092
BEDROOMS:	3
BATHROOMS:	1.0
LEVELS:	1

OPTIONAL FEATURES

- ☒ Green Certification
- ☒ Energy Star

Terrific starter home or a nice downsize choice for empty nesters! Enjoy the functional eat-in country kitchen that will be the setting for many cozy meals! Three good sized bedrooms to accommodate a budding family or whatever you can imagine; craft room, guest room, study. A nice sized living room/family area completes this ranch style floor plan.

FIRST FLOOR

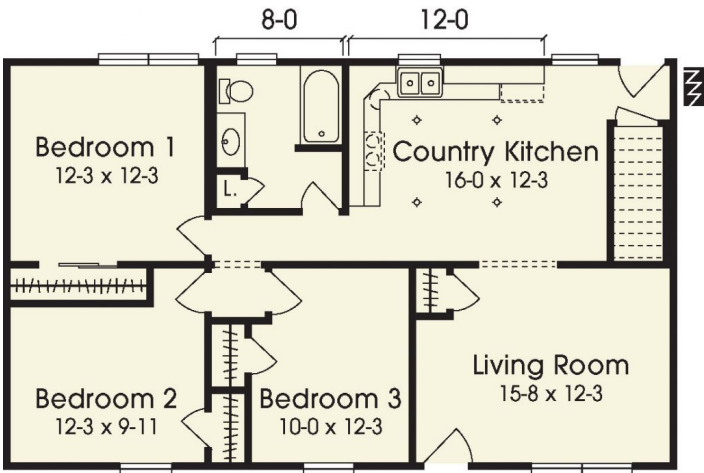

YOUR
NEW HOME
CONSULTANT



Hi, I'm Consultant Sales, your personal Modular Home Consultant

I would be happy to help you with any questions you may have. You can contact me on my direct number at **Not Available** or email me at contact@expressmodular.com.