

THE LAKE HOUSE. SVC-013

Traditional



SPECIFICATIONS

SQ. FT.	2559
BEDROOMS:	3
BATHROOMS:	3.0
LEVELS:	2

OPTIONAL FEATURES

- ☒ Green Certification
- ☒ Energy Star

The Lake House is perfect for entertaining family and friends. The spacious great room is a focal point of this home highlighted by the vaulted ceilings and window wall making for a great place to entertain friends or just hang out. By simply adding a deck or patio on the rear the full-length glass doors can exit to the outdoors from either end of the great room. The front Elevation is pictured includes the following optional or site provided features: two car garage, front and rear porch areas with railings, decorative columns, and stonework, front dormers, front door with sidelights, transom windows over doors and windows, window grills, and decorative fixed glass windows in the great room.

FIRST FLOOR

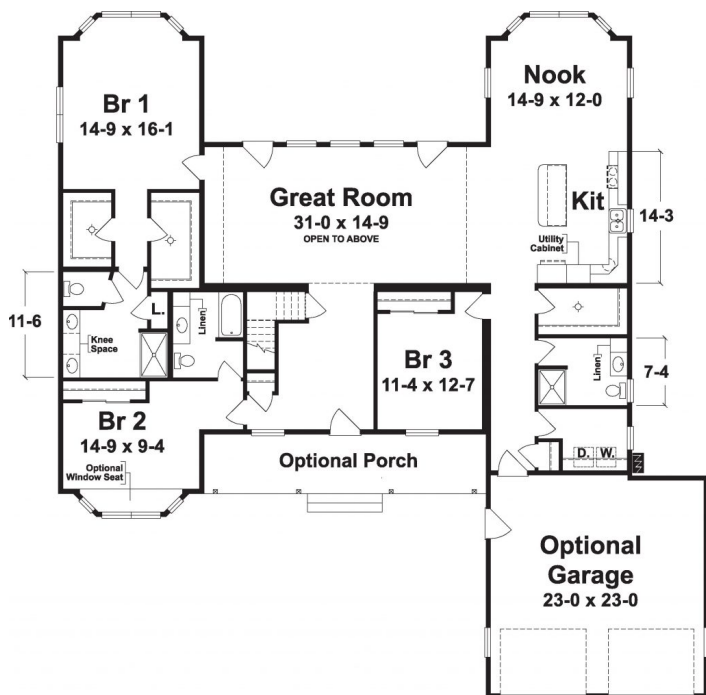

YOUR
NEW HOME
CONSULTANT

Hi, I'm , your personal Modular Home Consultant

I would be happy to help you with any questions you may have. You can contact me on my direct number at or email me at .