

ELKHORN. SVC-006

CabinChaletCoastalTraditional



SPECIFICATIONS

SQ. FT.	1576
BEDROOMS:	3
BATHROOMS:	2.0
LEVELS:	1.5

OPTIONAL FEATURES

- ☒ Green Certification
- ☒ Energy Star

The Elkhorn ranch is complimented by the use of casement windows in the living room and dining room as well as quarter round and half round windows in the vaulted area. The exterior elevation is standard with full glass exterior doors along with hanging lights. Optional features include a high pitched roof, cedar shakes and a decorative Korbels.

FIRST FLOOR

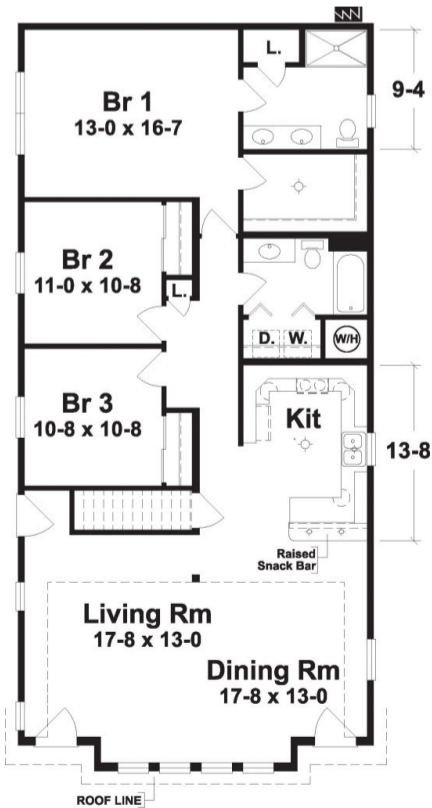

YOUR
NEW HOME



Hi, I'm Justin Bryant, your personal Modular Home Consultant



I would be happy to help you with any questions you may have. You can contact me on my direct number at **(877) 410-6334** or email me at justin.bryant@impresamodular.com.