

CEDARVIEW B. SVC-005

CoastalTraditional

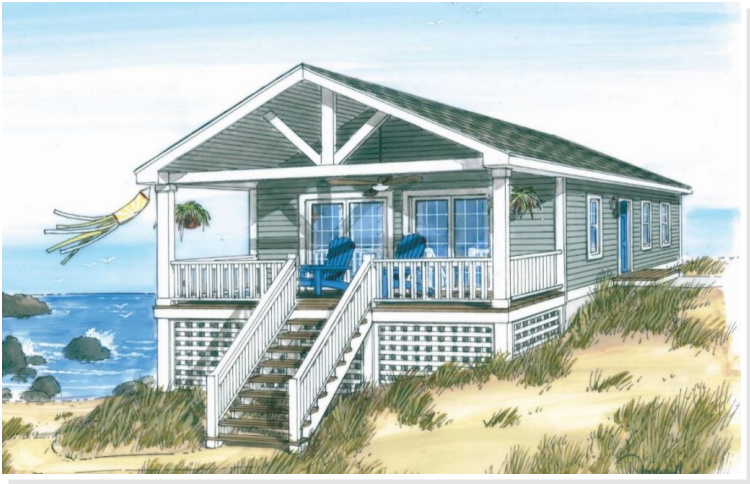

SPECIFICATIONS

SQ. FT.	1248
BEDROOMS:	3
BATHROOMS:	2.0
LEVELS:	1

OPTIONAL FEATURES

- ☒ Green Certification
- ☒ Energy Star

The standard features include a Gable Prow at the living room and dinning room.. Along with 6' patio doors. Flat 8' ceilings are standard throughout. The Cedar View has an open floor plan that you are sure to love.

FIRST FLOOR

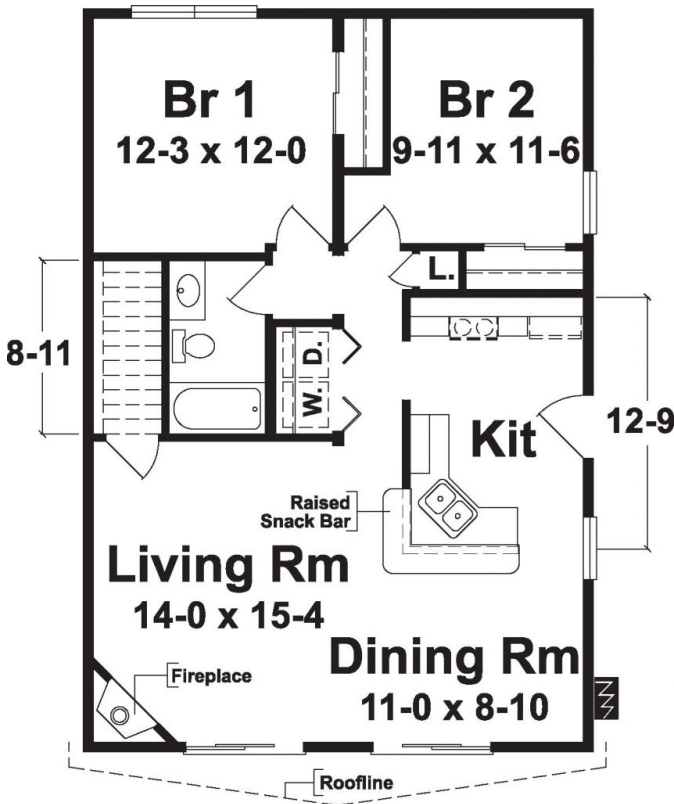

YOUR
NEW HOME
CONSULTANT



Hi, I'm Justin Bryant, your personal Modular Home Consultant

I would be happy to help you with any questions you may have. You can contact me on my direct number at (877) 410-6334 or email me at justin.bryant@impresamodular.com.