

CASCADE. SVC-003

ChaletTraditional



SPECIFICATIONS

SQ. FT.	2558
BEDROOMS:	2
BATHROOMS:	2.0
LEVELS:	1.5

OPTIONAL FEATURES

- ☒ Green Certification
- ☒ Energy Star

The open floor plan of the Cascade, as shown, is standard with dual railing at stairs on the first floor and decorative range hood as a kitchen backdrop. the plan also includes 8" patio doors at the Great room. The exterior is highlighted by prow walls and a large trapezoid windows that light up the Great Room vault. Master Suite is on one side of the home while the additional bedroom is on the other side for privacy. You can add an additional 873 square feet and two additional bedrooms by finishing the up stairs.

FIRST FLOOR

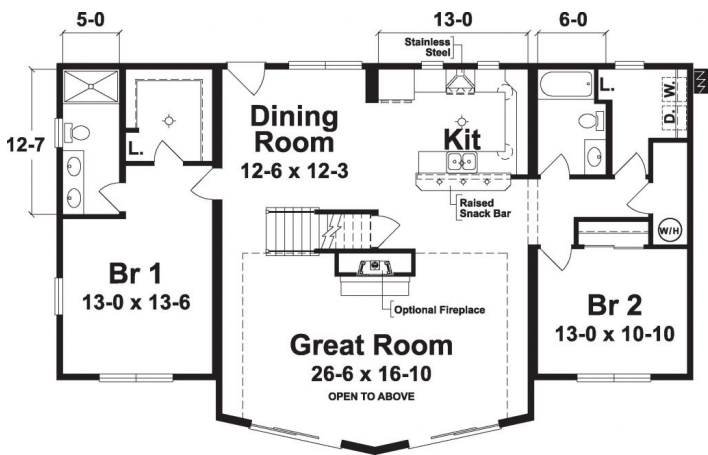

SUGGESTED SECOND FLOOR

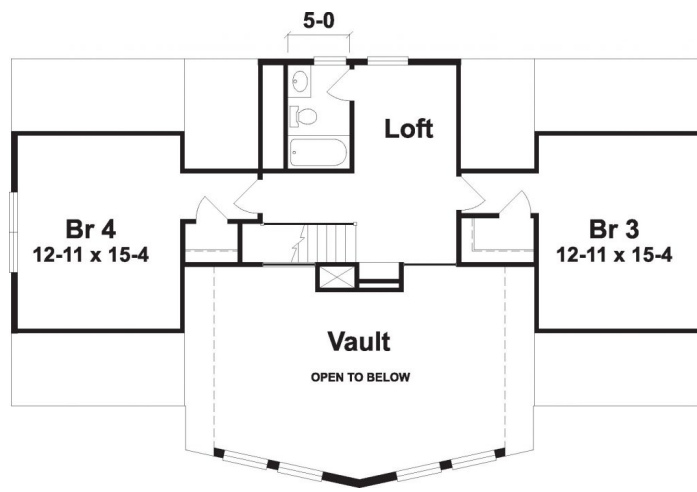

YOUR
NEW HOME
CONSULTANT

Hi, I'm , your personal Modular Home Consultant

I would be happy to help you with any questions you may have. You can contact me on my direct number at or email me at .