

SHEFFFIELD. EMH-007

Traditional



SPECIFICATIONS

SQ. FT.	2066
BEDROOMS:	3
BATHROOMS:	2.0
LEVELS:	1.0

OPTIONAL FEATURES

- ☒ Green Certification
- ☒ Energy Star

The Sheffield with all of its dormers, gabled roof and cover porch (on-site by others) has nice curb appeal and would look great in any area. Inside this glorious home you will find a U-Shaped kitchen with a snack bar that is open to the great room. Master bed room complete with master bath and large walk in closet plus two additional bed rooms and a hall bath.

FIRST FLOOR

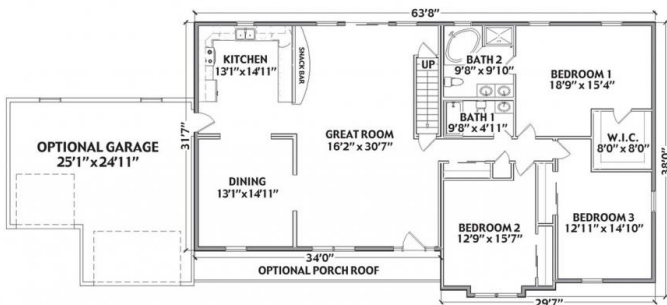

YOUR
NEW HOME
CONSULTANT

Hi, I'm , your personal Modular Home Consultant

I would be happy to help you with any questions you may have. You can contact me on my direct number at or email me at .