



SPECIFICATIONS

SQ. FT.	1515
BEDROOMS:	3
BATHROOMS:	2.0
LEVELS:	1.0

OPTIONAL FEATURES

- ☒ Green Certification
- ☒ Energy Star

With options including front porch and decorative dormer accents, the possibilities of the Shiloh home go on and on. Use your imagination and utilize this three-bedroom, two bath home to suit your lifestyle. Thoughtful design touches including an ample kitchen island bordering the dining room and well-placed windows for sunlight and views make the Shiloh a smart home option for anyone.

FIRST FLOOR

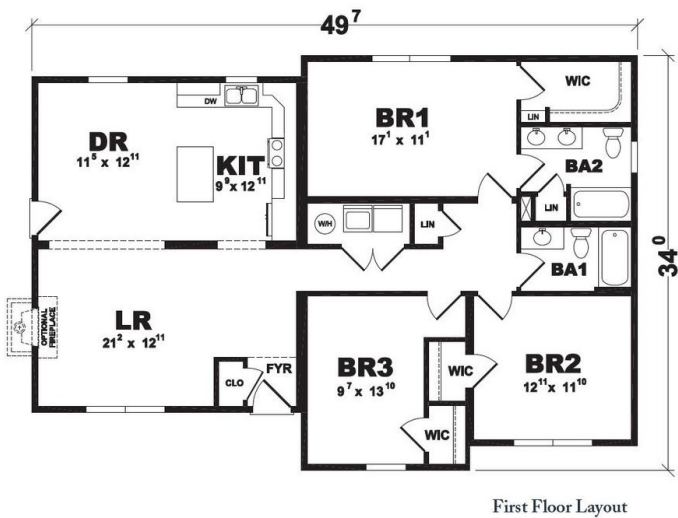

BASEMENT OPTION

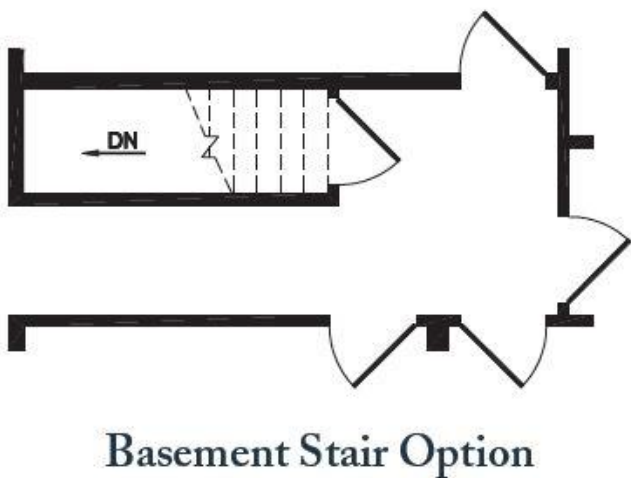

YOUR
NEW HOME
CONSULTANT



Hi, I'm Justin Bryant, your personal Modular Home Consultant

I would be happy to help you with any questions you may have. You can contact me on my direct number at **(877) 410-6334** or email me at justin.bryant@impresamodular.com.