

ELLSWORTH. CGC-004

Traditional



SPECIFICATIONS

SQ. FT.	2019
BEDROOMS:	3
BATHROOMS:	2.5
LEVELS:	2.0

OPTIONAL FEATURES

- ☒ Green Certification
- ☒ Energy Star

The Ellsworth is a beautiful and spacious home. With a total living area of 2,019 square feet, this home has plenty of room for a large family. The home features 3 bedrooms and 2.5 bathrooms. The exterior of the home has a classic look with a covered front porch and traditional gable roofline.

As you enter the home, you are greeted by a large open floor plan with a living room, breakfast nook, and kitchen all flowing together. The kitchen is equipped with modern appliances, ample cabinet space, and a curved island with a double sink. The first floor also features a formal dining room or den, a laundry room and a half bath.

Upstairs, the spacious master suite includes a large walk-in closet and a luxurious bathroom with a soaking tub, separate shower, and double vanities. The two spare bedrooms share a full bathroom. There is also the option of a balcony on the second level.

The Ellsworth is perfect for a family looking for a spacious and comfortable home with all the modern amenities.

FIRST FLOOR

SECOND FLOOR

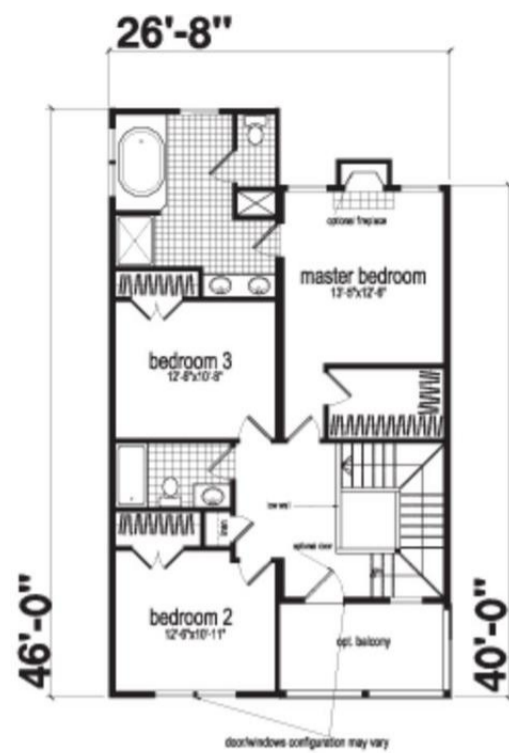

YOUR
NEW HOME
CONSULTANT



Hi, I'm Consultant Sales, your personal Modular Home Consultant

I would be happy to help you with any questions you may have. You can contact me on my direct number at **Not Available** or email me at contact@expressmodular.com.