

# DAUPHINE . CGC-002

Coastal



## SPECIFICATIONS

|            |      |
|------------|------|
| SQ. FT.    | 2383 |
| BEDROOMS:  | 4    |
| BATHROOMS: | 2.5  |
| LEVELS:    | 2.0  |

## OPTIONAL FEATURES

- Green Certification
- Energy Star

The Dauphine is a beautiful house plan that offers a spacious and functional living space. The home has a total living area of 2,383 square feet and features four bedrooms, two and a half bathrooms, and an open living area that encompasses the dining, and living room.

As you enter the home, you are greeted by a spacious living room that flows into the dining area. The kitchen is equipped with modern appliances, a large end island, and ample counter space, making it perfect for cooking and entertaining. The dining area is conveniently located adjacent to the kitchen, providing a comfortable space to enjoy meals with family and friends. This plan also provides a breakfast nook and a large family room with a half bath and laundry room on the main level providing a convenient space to take care of household chores.

Additionally, there are 2 spacious covered porches that offer the perfect place to relax and enjoy the outdoors.

The master bedroom is located on the second level of the home and features a large walk-in closet and an ensuite bathroom with dual sinks, a shower and soaking tub. The other three bedrooms are located on this level and feature walk-in closets. The second bathroom is conveniently located between the bedrooms and features a bathtub and shower combination.

This house plan is designed to be energy-efficient, with features such as high-efficiency HVAC systems and Energy Star appliances. It is also customizable, allowing homeowners to make changes and additions to fit their unique needs and preferences. Overall, the Dauphine is a beautiful and functional home that is perfect for families or individuals looking for a spacious and modern living space.

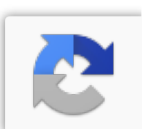

FIRST FLOOR



SECOND FLOOR

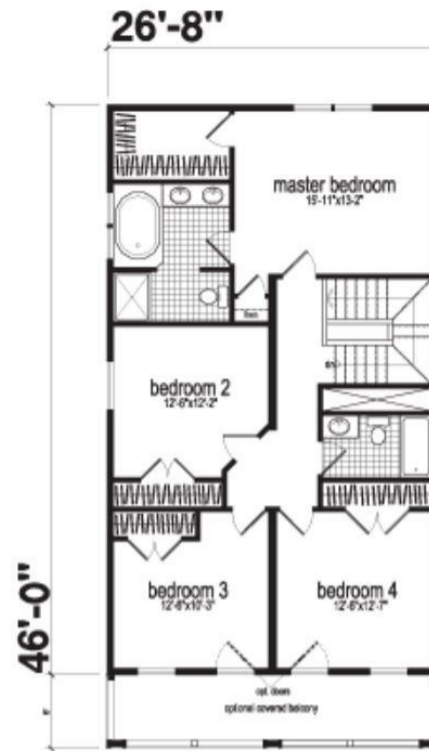

YOUR  
NEW HOME  
CONSULTANT



Hi, I'm Justin Bryant, your personal Modular Home Consultant

I would be happy to help you with any questions you may have. You can contact me on my direct number at **(877) 410-6334** or email me at [justin.bryant@impresamodular.com](mailto:justin.bryant@impresamodular.com).