

THE MAYFIELD. HCC-038

Traditional



SPECIFICATIONS

| | |
|------------|------|
| SQ. FT. | 2357 |
| BEDROOMS: | 3 |
| BATHROOMS: | 3.5 |
| LEVELS: | 1.5 |

OPTIONAL FEATURES

- ☒ Green Certification
- ☒ Energy Star

The Mayfield is a beautiful and spacious one and a half-story home plan. This home features 3 bedrooms, 3.5 bathrooms. The first floor of the Mayfield is designed with an open concept layout, which includes a living room, dining area, and kitchen with a large center island. The living room has an optional cozy fireplace and there is a large laundry area, a walk in pantry and a half bath. The first floor has the master suite with its own ensuite bathroom complete with soaker tub and separate shower. Two additional bedrooms with full bathrooms and a sitting area are located on the second floor which could be used as a playroom or home office. The Mayfield is a stunning home plan that offers plenty of space for families to grow and entertain.

FIRST FLOOR



SUGGESTED SECOND FLOOR

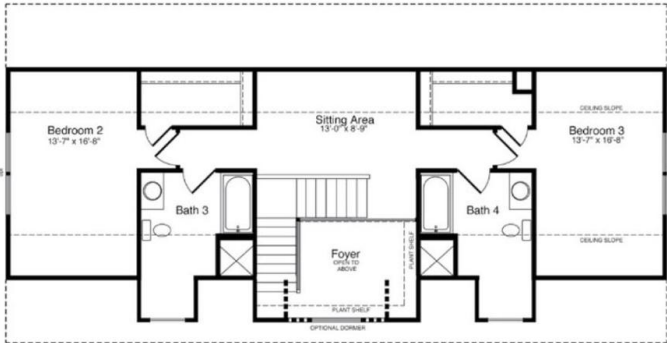

YOUR
NEW HOME
CONSULTANT

Hi, I'm , your personal Modular Home Consultant

I would be happy to help you with any questions you may have. You can contact me on my direct number at or email me at .