

THE POPLAR. HCR-015

Traditional



SPECIFICATIONS

SQ. FT.	1207
BEDROOMS:	3
BATHROOMS:	2.0
LEVELS:	1.0

OPTIONAL FEATURES

- ☒ Green Certification
- ☒ Energy Star

A magnificent kitchen/dining room combination highlights The Poplar. The optional bump-out window enhances the home’s appeal. Three bedrooms and two full baths complete the design of this ranch home.

FIRST FLOOR

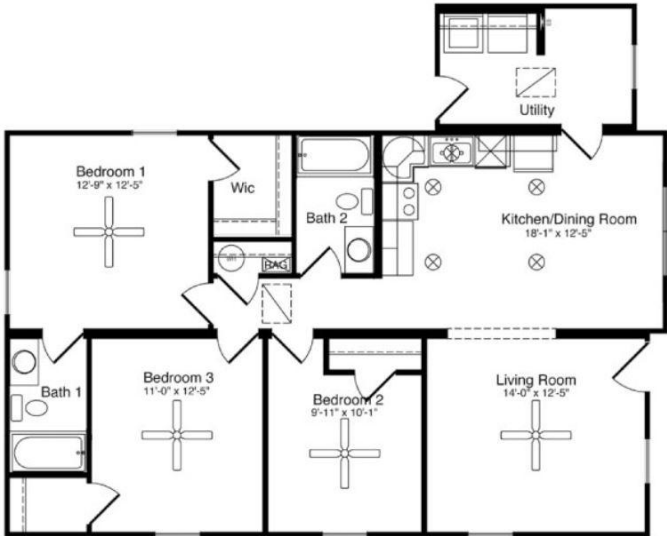

YOUR
NEW HOME
CONSULTANT

Hi, I'm , your personal Modular Home Consultant

I would be happy to help you with any questions you may have. You can contact me on my direct number at or email me at .