

LUCINDA . NNC-034

Traditional



SPECIFICATIONS

SQ. FT.	2100
BEDROOMS:	2
BATHROOMS:	2.0
LEVELS:	1.5

OPTIONAL FEATURES

- Green Certification
- Energy Star

FIRST FLOOR

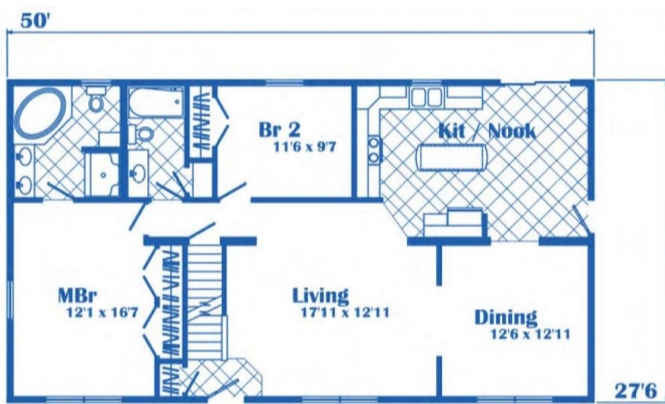

YOUR
NEW HOME
CONSULTANT



Hi, I'm , your personal Modular Home Consultant

I would be happy to help you with any questions you may have. You can contact me on my direct number at or email me at .

