

# FAYETTE . HES-008

Traditional



## SPECIFICATIONS

SQ. FT.	1728
BEDROOMS:	3
BATHROOMS:	2.0
LEVELS:	1.0

## OPTIONAL FEATURES

- Green Certification
- Energy Star

The Fayette's Specific Features - o Attractive Front Elevation o Laundry Off Rear Foyer o Traditional Entry Foyer o Dining Room, Family Room and Kitchen Centrally Located

### FIRST FLOOR



### CRAWL SPACE OPTION

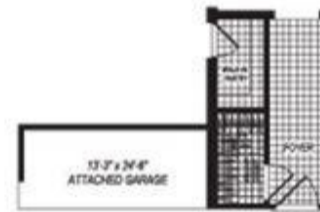

YOUR  
NEW HOME  
CONSULTANT



Hi, I'm , your personal Modular Home Consultant

I would be happy to help you with any questions you may have. You can contact me on my direct number at or email me at .

