

CAPE ELLSWORTH. HHC-039

Traditional



SPECIFICATIONS

SQ. FT.	2320
BEDROOMS:	3
BATHROOMS:	2.5
LEVELS:	1.5

OPTIONAL FEATURES

- ☒ Green Certification
- ☒ Energy Star

This 1,700 square foot floor plan provides ample space in its 3 bedroom, 2.5 bath design. Created with an optional wrap-around porch, the Cape Ellsworth has beautiful features and unique extras in every room. From the secluded master suite, to the enormous living room, the Cape Ellsworth is designed for efficiency. Plus, its unique design is ideal for a narrow lot or corner lot locations.

Note: Cape Models come with an unfinished 2nd floor that can be completed on site. Listed square footage, bedrooms and baths include 2nd story living.

FIRST FLOOR



SECOND FLOOR

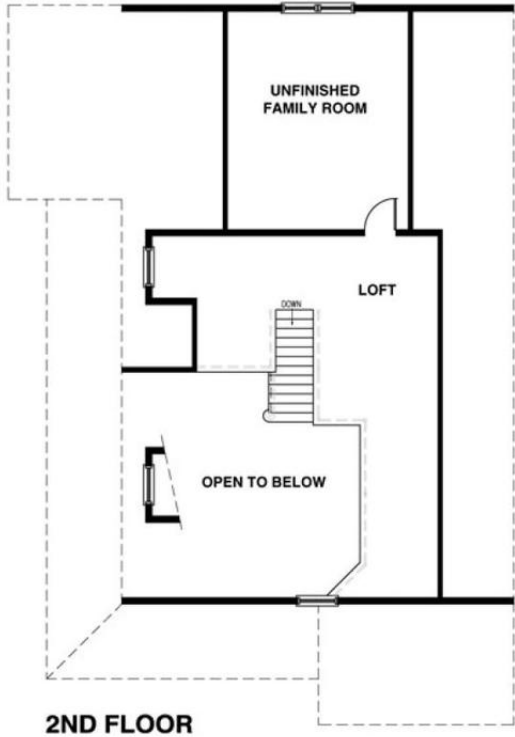

YOUR

Hi, I'm , your personal Modular Home Consultant

I would be happy to help you with any questions you may have. You can contact me on my direct number at or email me at .