

# SHILOH. EAH-013

Traditional



### SPECIFICATIONS

SQ. FT.	1515
BEDROOMS:	3
BATHROOMS:	2.0
LEVELS:	1.0

### OPTIONAL FEATURES

- ☒ Green Certification
- ☒ Energy Star

With options including front porch and decorative dormer accents, the possibilities of the Shiloh home go on and on. Use your imagination and utilize this three-bedroom, two bath home to suit your lifestyle. Thoughtful design touches including an ample kitchen island bordering the dining room and well-placed windows for sunlight and views make the Shiloh a smart home option for anyone.

#### FIRST FLOOR

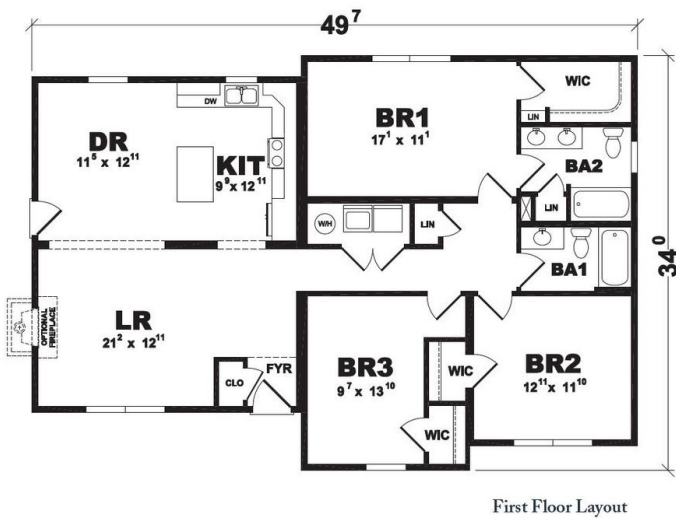

#### BASEMENT OPTION

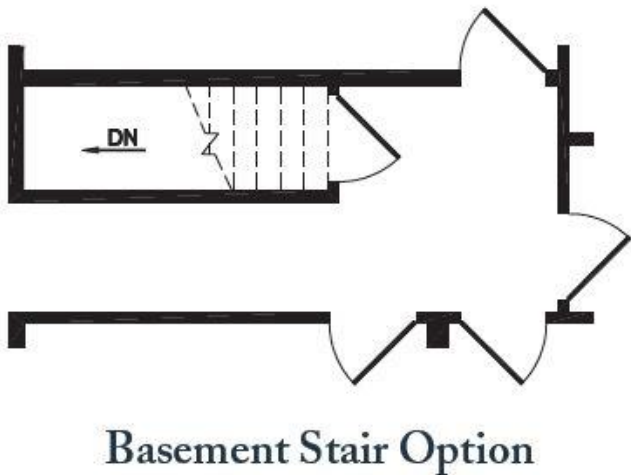

YOUR  
NEW HOME  
CONSULTANT

Hi, I'm , your personal Modular Home Consultant

I would be happy to help you with any questions you may have. You can contact me on my direct number at or email me at .