

# RUSTBURG. MCS-035

Log Style



## SPECIFICATIONS

SQ. FT.	1736
BEDROOMS:	4
BATHROOMS:	2.0
LEVELS:	1.5

## OPTIONAL FEATURES

- ☒ Green Certification
- ☒ Energy Star

The Rustburg is a spacious and luxurious modular home plan. With over 1,700 square feet of living space, this home boasts four bedrooms, 2 bathrooms, a large living room, dining room and kitchen. The first floor also includes the primary bedroom, bedroom 2 and a bathroom. The second floor features two more bedrooms and a full bathroom. There is also a basement alternative. The Rustburg's exterior features a welcoming front porch.

### FIRST FLOOR

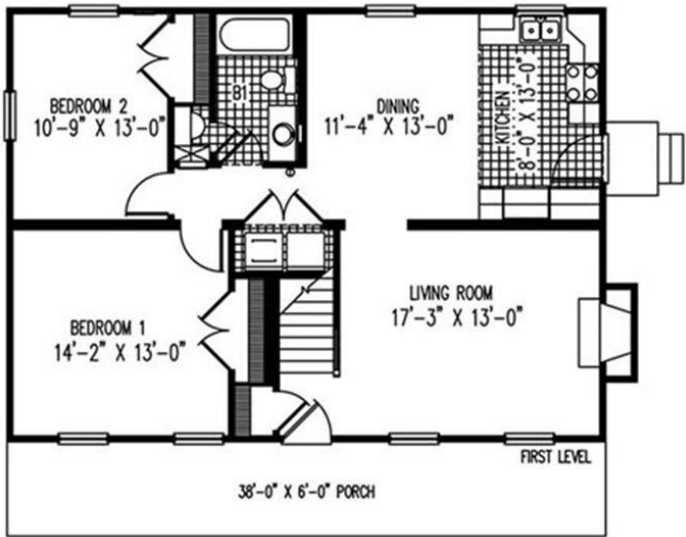

### SECOND FLOOR

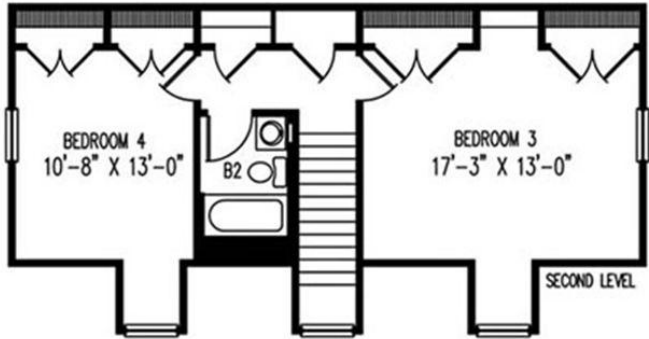

YOUR  
NEW HOME  
CONSULTANT

Hi, I'm , your personal Modular Home Consultant

I would be happy to help you with any questions you may have. You can contact me on my direct number at or email me at .