

PALMYRA. ETS-029

Traditional



SPECIFICATIONS

SQ. FT.	1762
BEDROOMS:	3
BATHROOMS:	2.0
LEVELS:	1.0

OPTIONAL FEATURES

- ☒ Green Certification
- ☒ Energy Star
- ☒ Garage Included

The pleasure of Palmyra. Entertaining areas to the rear of the home take full advantage of backyard views. The country kitchen with built-in desk has space for a dinette. Placement of the closets and bath rooms provides peaceful solitude for the master bedroom.

FIRST FLOOR

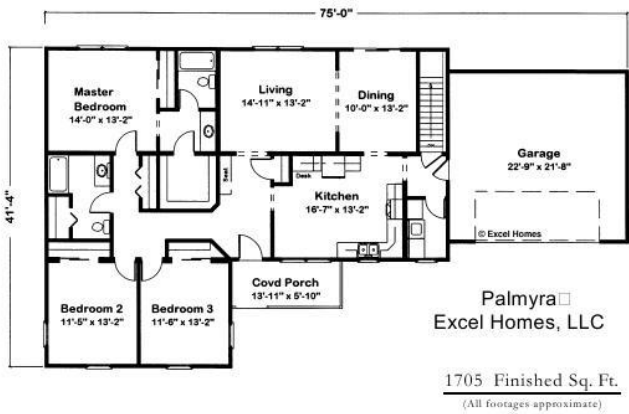

YOUR
NEW HOME
CONSULTANT

Hi, I'm , your personal Modular Home Consultant

I would be happy to help you with any questions you may have. You can contact me on my direct number at or email me at .