

CRESTWOOD 4A . ETS-014

Traditional



SPECIFICATIONS

SQ. FT.	1529
BEDROOMS:	3
BATHROOMS:	2.0
LEVELS:	1.0

OPTIONAL FEATURES

- Green Certification
- Energy Star

All the comforts of Crestwood IV A. Open entry views add to the feeling of spaciousness. An accommodating pantry and abundant work space in the peninsula kitchen. For the master bedroom -- two closets plus a bath with separate tub and shower.

FIRST FLOOR

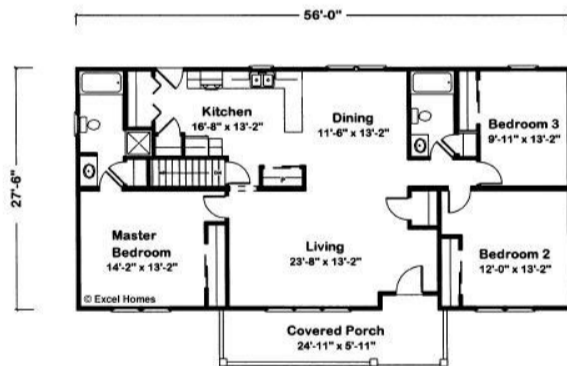

Crestwood IV A
Excel Homes, LLC

1497 Finished Sq. Ft.
(All footages approximate)

YOUR
NEW HOME
CONSULTANT



Hi, I'm , your personal Modular Home Consultant

I would be happy to help you with any questions you may have. You can contact me on my direct number at or email me at .

