

TIDEWATER. EGT-010

Traditional



SPECIFICATIONS

SQ. FT.	3139
BEDROOMS:	3
BATHROOMS:	2.5
LEVELS:	2.0

OPTIONAL FEATURES

- ☒ Green Certification
- ☒ Energy Star
- ☒ Garage
- Included

With its first floor master suite and three large upstairs bedrooms with walk-in closets, the Tidewater is a great family home. Presented in a traditional farmhouse style, it comes with 3½ baths, a separate study with optional fireplace, two-car garage, large formal dining room and professionally designed eat-in kitchen with oversized center island, separate cooktop and oven, and large storage pantry

FIRST FLOOR



SECOND FLOOR

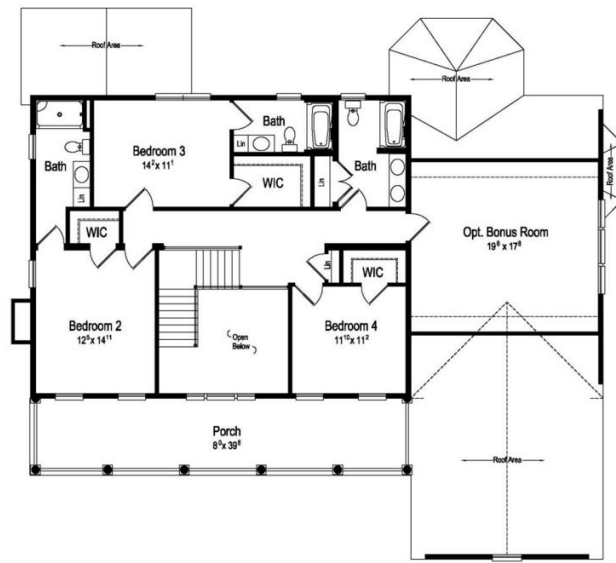

OPTIONAL MASTER BATH

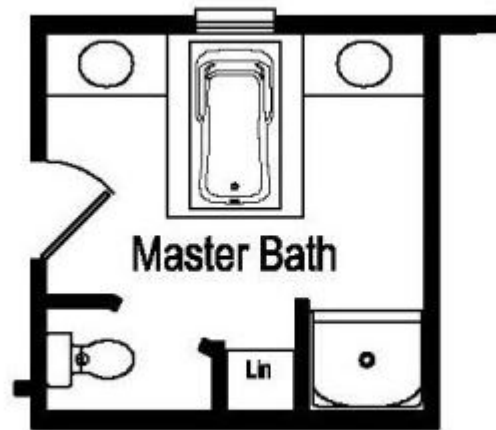

YOUR
NEW HOME
CONSULTANT

Hi, I'm , your personal Modular Home Consultant

I would be happy to help you with any questions you may have. You can contact me on my direct number at or email me at .