

SEAVIEW . EGT-007

Contemporary



SPECIFICATIONS

SQ. FT.	1972
BEDROOMS:	3
BATHROOMS:	2.5
LEVELS:	2.0

OPTIONAL FEATURES

- Green Certification
- Energy Star

Designed to be built on piers, the Coastal-style Seaview home plan can also be built on traditional foundations and fits most narrow lots. The inverted floor plan offers 3 bedrooms and 2½ baths, including a master with separate shower and tub, with the option of 9-foot ceilings on both floors. Expansive rear sliding doors provide perfect access to outdoor enjoyment on porches and decks. Other amenities include an open great room, a professionally designed kitchen with large pantry and raised breakfast bar, a separate breakfast room and dining room. There's space for parking on the ground level under the home.

FIRST FLOOR



SECOND FLOOR

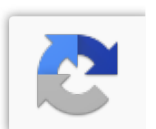
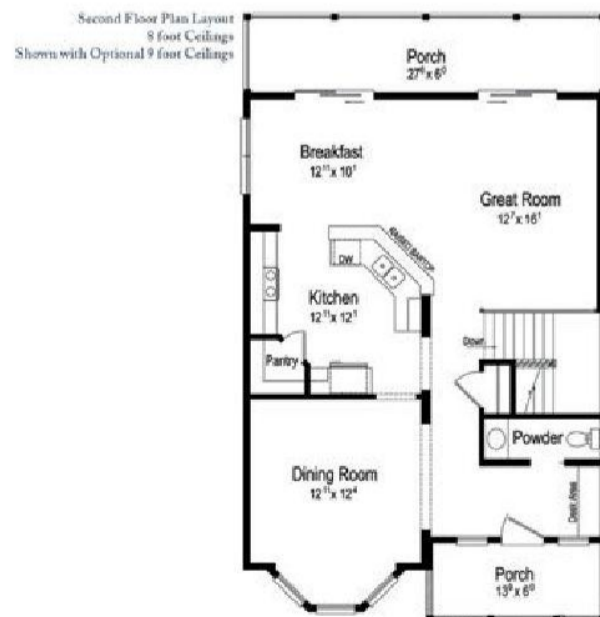

YOUR
NEW HOME
CONSULTANT



Hi, I'm , your personal Modular Home Consultant

I would be happy to help you with any questions you may have. You can contact me on my direct number at or email me at .

