

# CENTRALIA . EGR-007

Traditional



## SPECIFICATIONS

SQ. FT.	2555
BEDROOMS:	3
BATHROOMS:	2.5
LEVELS:	1.0

## OPTIONAL FEATURES

- Green Certification
  - Energy Star
  - Garage
- Included

With its unmatched design features, the Centralia plan is sure to capture your imagination. Back-to-back fireplaces grace the sensational window-bedecked great room and charming keeping room, perfect for family gatherings because the kitchen is close by and provides a pleasing center island. A breakfast room and a regal formal dining room expand your mealtime and entertainment options. A sizable pantry, a voluminous laundry room and a cute powder room are all efficiently located. When it's time for some pampering, escape to the sweeping master bedroom, complete with a walk-in closet and alluring master bath with a whirlpool or soaking tub, shower, dual sinks with extra counter space and a private toilet area. The Centralia also provides a rear two-car garage for maximum curb appeal, two additional bedrooms, one of which could be used as a study, and another full bath. There is an optional kitchen plan available.

### FIRST FLOOR



### OPTIONAL KITCHEN

#### OPTIONAL KITCHEN

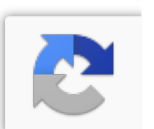
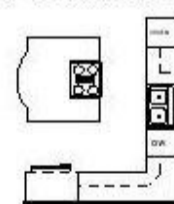

YOUR  
NEW HOME  
CONSULTANT



**Hi, I'm , your personal Modular Home Consultant**

I would be happy to help you with any questions you may have. You can contact me on my direct number at or email me at .

