

# FAIRVIEW . EEL-010

Traditional



## SPECIFICATIONS

SQ. FT.	2003
BEDROOMS:	3
BATHROOMS:	2.5
LEVELS:	2.0

## OPTIONAL FEATURES

- Green Certification
- Energy Star
- Garage Included

A gabled porch with a side entrance gives this 1 1/2 story home an interesting twist. Busy adults will relish stepping behind the French doors off the entry into the den's quiet solitude. When it's time to entertain, the 2-story great room is sure to dazzle -- with its fireplace, stacked windows, gracious staircase and expansive plant shelf. The second level offers a computer room for the children.

### FIRST FLOOR

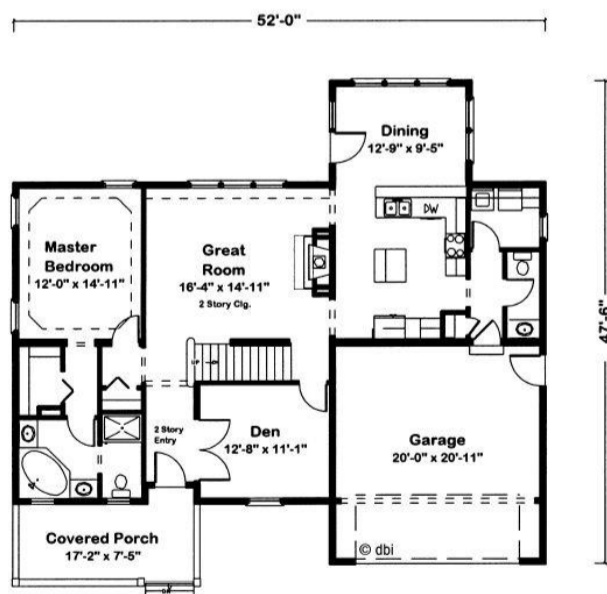

### SECOND FLOOR



YOUR  
NEW HOME  
CONSULTANT



Hi, I'm , your personal Modular Home Consultant

I would be happy to help you with any questions you may have. You can contact me on my direct number at or email me at .

