

ORCHARD VALLEY. EEL-017

Traditional



SPECIFICATIONS

SQ. FT.	1390
BEDROOMS:	3
BATHROOMS:	2.5
LEVELS:	1.0

OPTIONAL FEATURES

- ☒ Green Certification
- ☒ Energy Star
- ☒ Garage
- Included

Simple lines create an understated sophistication. The open living areas make the home feel spacious and encourage casual get-togethers. A door in the dining area provides convenient access when grilling in the backyard. Separated from secondary bedrooms, the master suite offers a quiet place to take a relaxing bath or grab a quick nap.

FLOOR PLAN

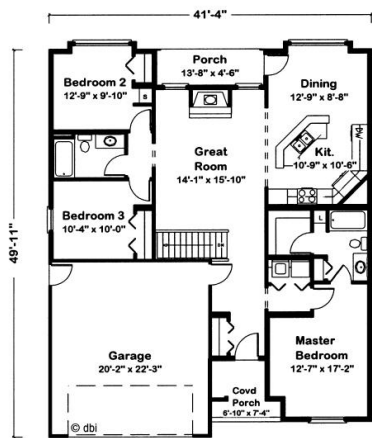

Excel Homes, LLC

Orchard Valley
1390 Finished Sq. Ft.
(All footages approximate)

YOUR
NEW HOME
CONSULTANT

Hi, I'm , your personal Modular Home Consultant

I would be happy to help you with any questions you may have. You can contact me on my direct number at or email me at .