

HAMILTON 2A

WINDOWS	EXT. DOORS	INT. DOORS	KIT. CAB.
(17) - #4	(1) - STD. 'A'	(13) - PASSAGE	20.25 FT. - WALL CAB.
(2) - #1	(1) - STD. 'B'	(5) - SLIDER	22.5 FT. - BASE CAB.

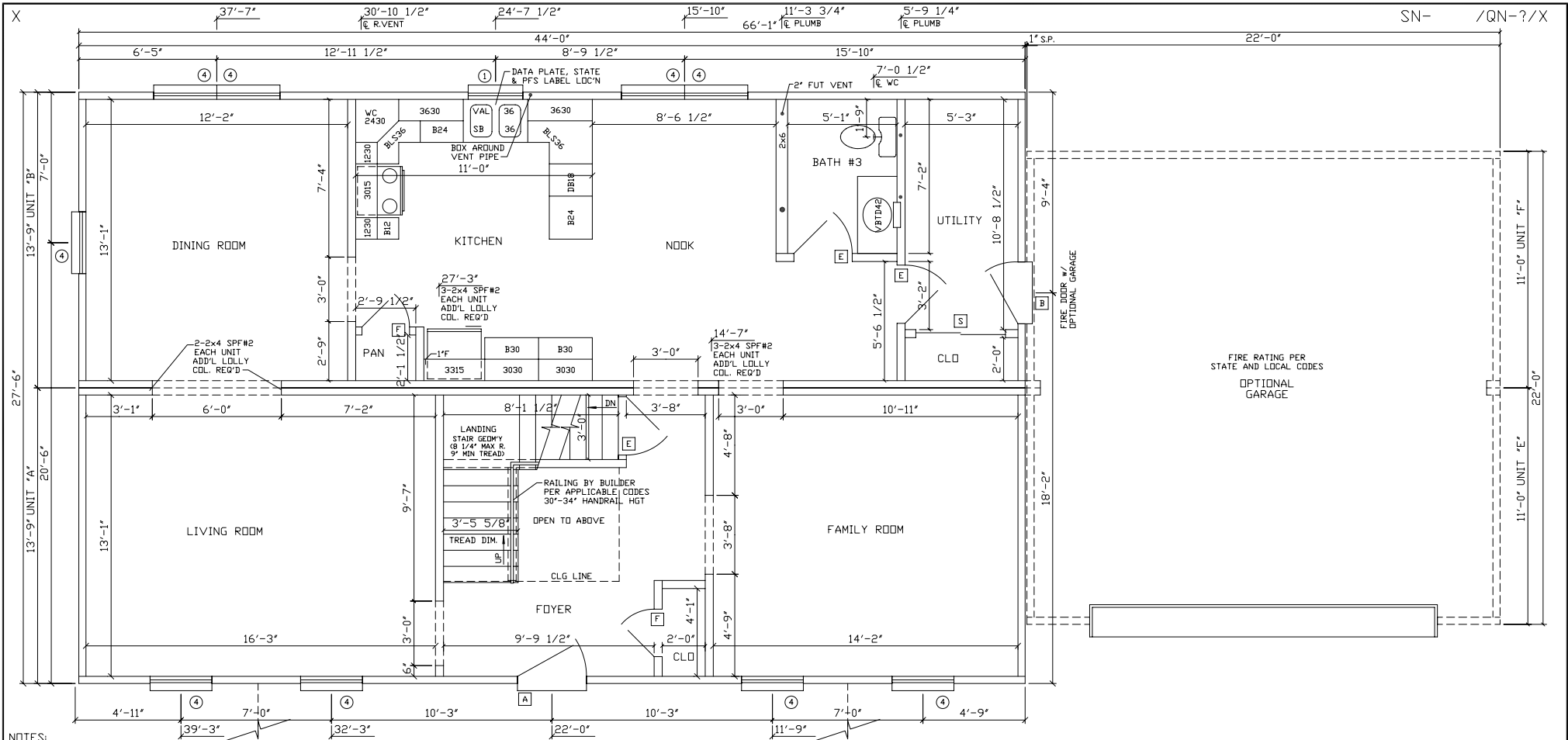

- NOTES:
- 2x4 SPF#2 EXT WALLS @ 16" O.C./2x4 MARR WALLS
 - 8'-0" CLG HT.
 - 2x10 SPF#2 FLOOR JOISTS @ 16" O.C.
 - 7'-0" SINGLE HUNG WINDOWS (#1=24210, #2=2842, #3=3048, #4=2852, #11=2558C)
 - CEILING DRYWALL WILL BE OMITTED FOR ALL ON-SITE PLUMBING CONNECTIONS
- OPTIONAL COVERED PORCH

excel
Homes
 FROM THE INSIDE

R.R.#2 BOX 683
 LIVERPOOL, PA 17045
 (717) 444-3395
 FAX (717) 444-7577
 WWW.EXCELHOMES.COM

27⁶44 HAMILTON 2A
 1ST STORY

DRAWN BY:	CHECKED BY:	DATE:	SCALE: 1/4"=1'-0"
REVISIONS:			DISK NO: HAM2A

01/14/02 08:19

SN- /QN-?/X

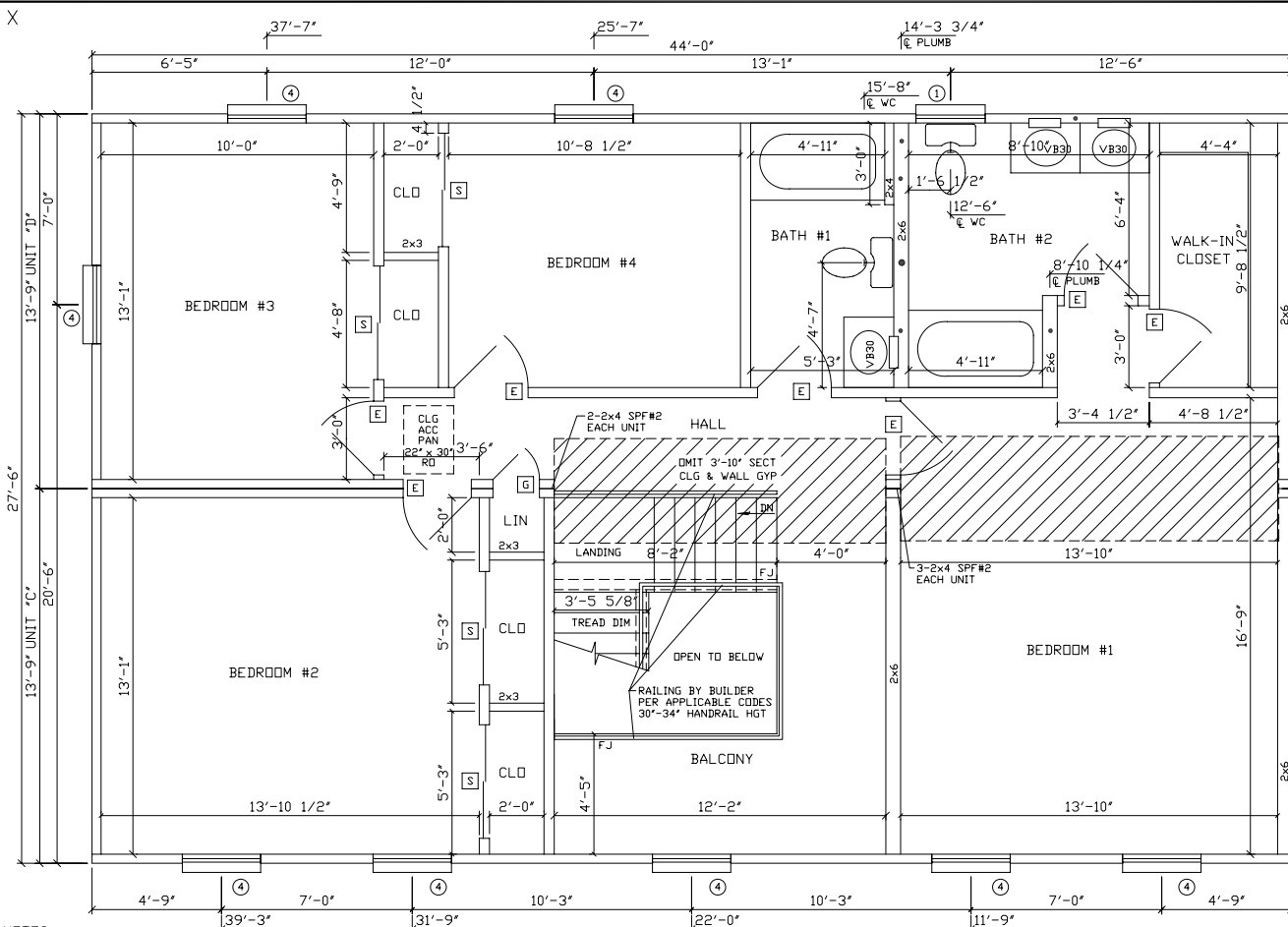

- NOTES:
1. 2x4 SPF#2 EXT WALLS @ 16" O.C./2x4 MARR WALLS (EXCEPT AS NOTED)
 2. 8'-0" CLG HT.
 3. 2x10 SPF#2 FLOOR JOISTS @ 16" O.C.
 4. ROOF SYSTEM TO BE 24" O.C.
 5. 7-D SINGLE HUNG WINDOWS (#1=24210, #2=2842, #3=3048, #4=2852, #11=2558C)
 6. CLG BEAM OVER BR#1/HALL TO BE: 2-1 1/2"x12"x35'-0" ML.

excel
Homes
 FROM THE INSIDE

R.R.#2 BOX 683
 LIVERPOOL, PA 17045
 (717) 444-3395
 FAX (717) 444-7577
 WWW.EXCELHOMES.COM

27 ⁶ 44 HAMILTON 2A 2ND STORY			
DRAWN BY:	CHECKED BY:	DATE:	SCALE: 1/4"=1'-0"
REVISIONS: REV. STD 10-29-01			DISK NO: HAM2A
01/14/02 0819			