

EDISON 2A

| WINDOWS | EXT. DOORS | INT. DOORS | KIT. CAB. |
|-------------|----------------|----------------|----------------------|
| (5) - #11 | (1) - STD. 'A' | (18) - PASSAGE | 17.75 FT - WALL CAB. |
| (7) - #1 | (2) - STD. 'B' | (2) - BIFOLD | 20.5 FT - BASE CAB. |
| (4) - #3 | | (3) - SLIDERS | |
| (12) - 3058 | | | |

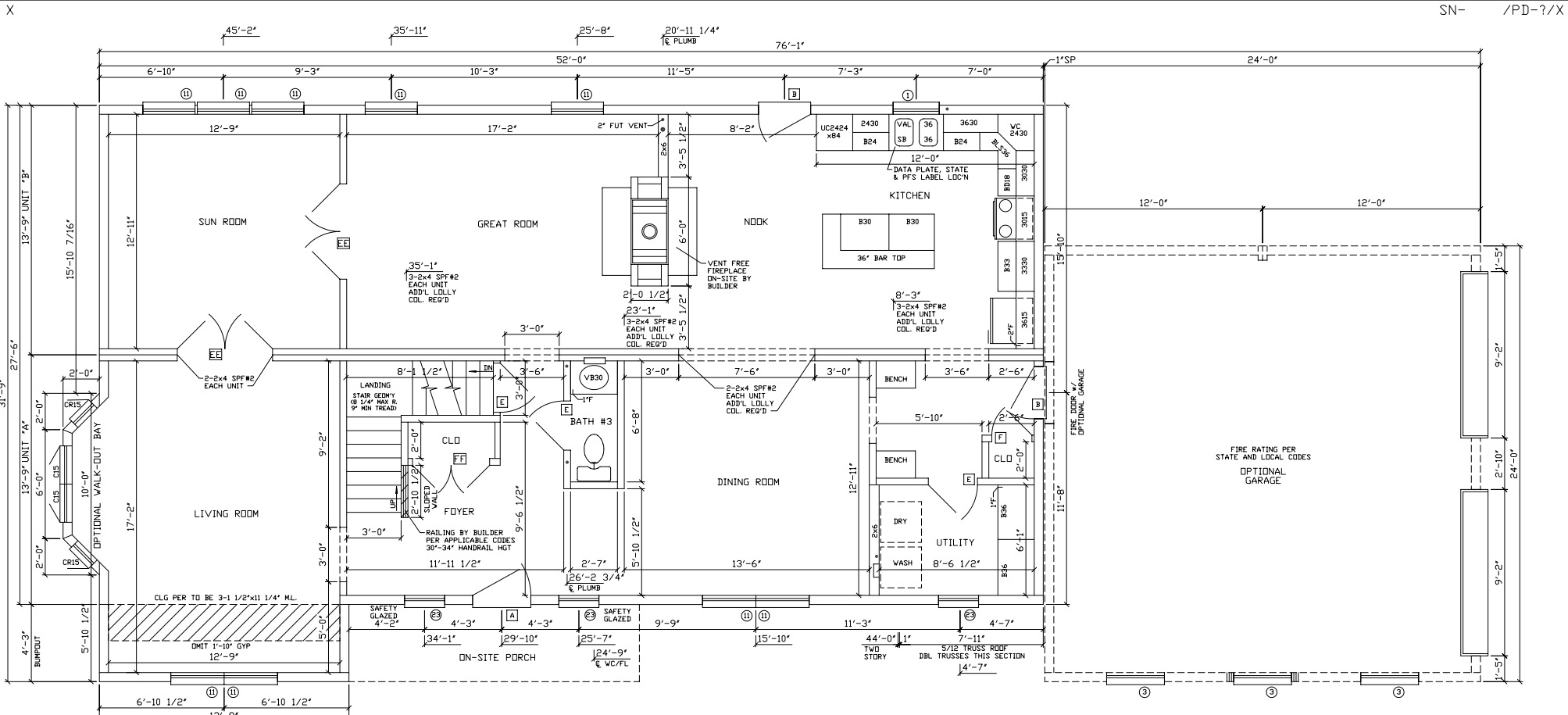

- NOTES:
1. 2x6 EXT WALLS @ 16" O.C./2x4 MARR WALLS
 2. 8'-0" CLG HT.
 3. 2x10 SPF#2 FLOOR JOISTS @ 16" O.C.
 4. ROOF SYSTEM TO BE 24" O.C.
 5. 7-D SINGLE HUNG WINDOWS (#1=24210, #2=2842, #3=3048, #4=2852, #11=2858C)
 6. CEILING DRYWALL WILL BE OMITTED FOR ALL ON-SITE PLUMBING CONNECTIONS

excel
homes
 FROM THE INSIDE

R.R.#2 BOX 683
 LIVERPOOL, PA 17045
 (717) 444-3395
 FAX (717) 444-7577
 WWW.EXCELHOMES.COM

27⁶ 52 EDISON 2A
 w/BUMPOUT
 1ST STORY

SCALE: 1/4"=1'-0"
 DISK NO: EDIS-2A6

DRAWN BY: _____ CHECKED BY: _____ DATE: _____
 REVISIONS: _____

01/25/02 0855

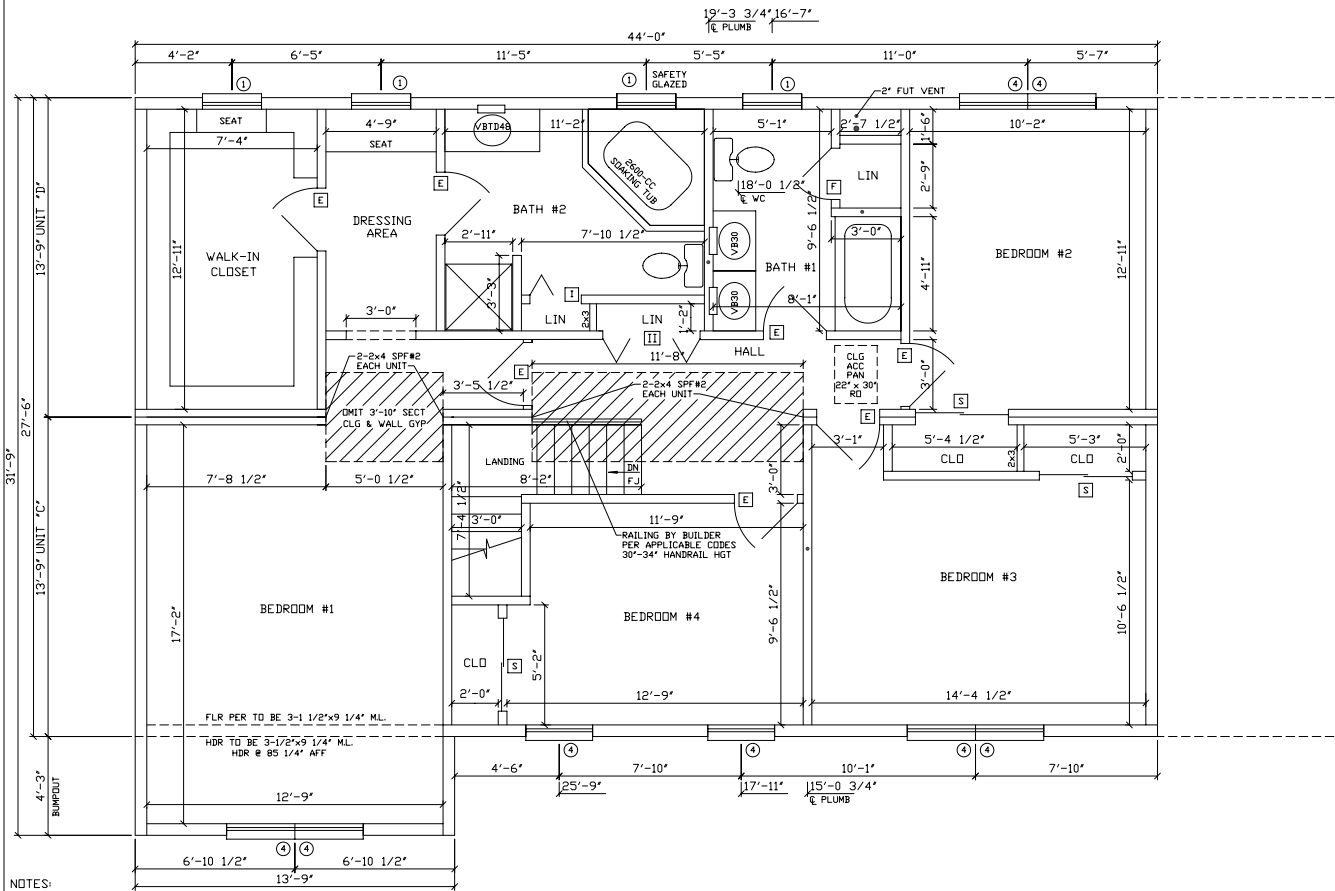

- NOTES:
 1. 2x6 EXT WALLS @ 16" O.C./2x4 MARR WALLS
 2. 8'-0" CLG HT.
 3. 2x10 SPF #2 FLOOR JOISTS @ 16" O.C.
 4. ROOF SYSTEM TO BE 24" O.C.
 5. 7-D SINGLE HUNG WINDOWS (#1=24210, #2=2842, #3=3048, #4=2852, #11=2858C)

excel
Homes
 FROM THE INSIDE

R.R.#2 BOX 683
 LIVERPOOL, PA 17045
 (717) 444-3395
 FAX (717) 444-7577
 WWW.EXCELHOMES.COM

27⁶ 44 EDISON 2A
 w/BUMP OUT
 2ND STORY

| | | | |
|------------|-------------|-------|----------------------|
| DRAWN BY: | CHECKED BY: | DATE: | SCALE: 1/4"=1'-0" |
| REVISIONS: | | | DISK NO: EDIS-2A6 |