

CARBONDALE

WINDOWS	EXT. DOORS	INT. DOORS	KIT. CAB.
(2) - #1	(1) - STD. 'A'	(14) - PASSAGE	19.25 FT - WALL CAB.
(2) - #2442 (SAFETY)	(3) - STD. 'B'	(2) - DBL BIFOLD	23.5 FT - BASE CAB.
(14) - #3		(3) - SLIDER	UC242484 w/SHELF KIT
(5) - 3058			
(1) - #1 SAFETY			
(1) - #3 SAFETY			

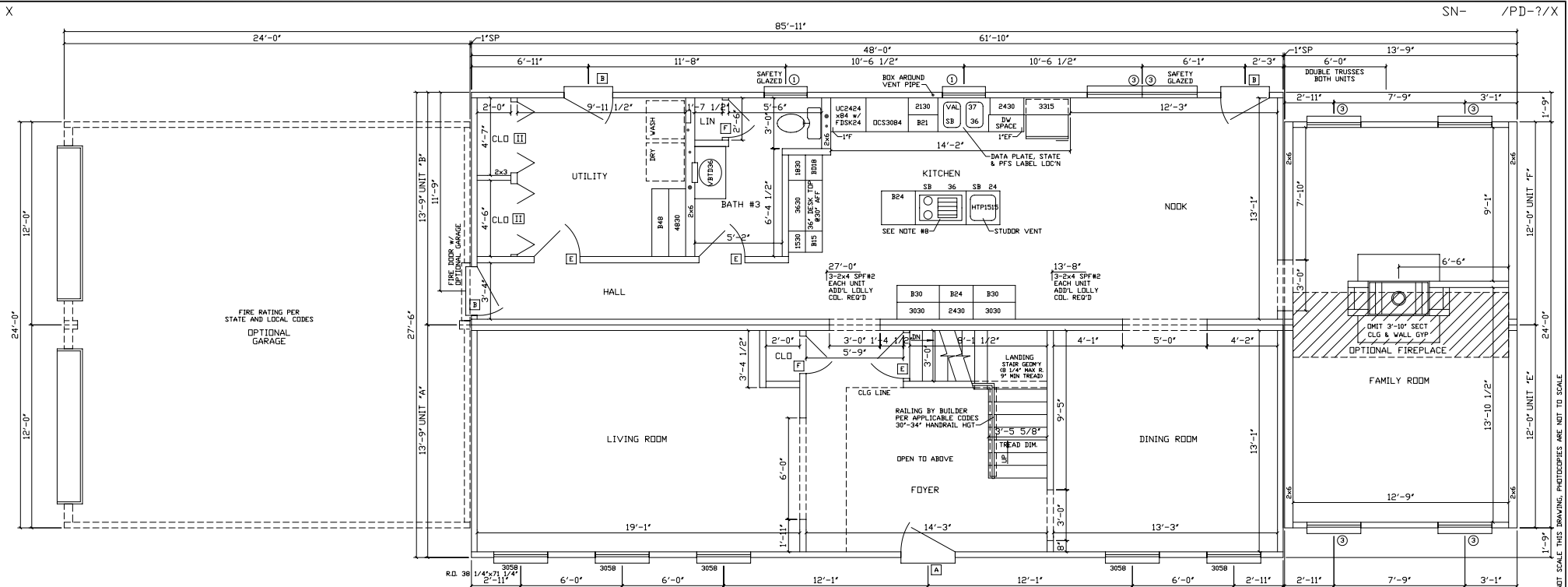

- NOTES:
- 2x4 SPF#2 EXT WALLS @ 16' O.C./2x4 MARR WALLS (EXCEPT AS NOTED)
 - 8'-0" CLG HT.
 - 2x10 SPF#2 FLOOR JOISTS @ 16' O.C.
 - ROOF SYSTEM TO BE 24' O.C.
 - 7-D SINGLE HUNG WINDOWS (#1=24210, #2=2842, #3=3048, #4=2852, #11=2858C)
 - CEILING DRYWALL WILL BE OMITTED FOR ALL ON-SITE PLUMBING CONNECTIONS
 - CLG BEAM OVER FAMILY TO BE 2-1 1/2"x18"x14'-0" ML
 - RANGE VENTING BY BLDG PER ALL APPLICABLE CODES

excel R.R.#2 BOX 683
 LIVERPOOL, PA 17045
 (717) 444-3395
 FAX (717) 444-7577
 FROM THE INSIDE WWW.EXCELHOMES.COM

276 48 CARBONDALE
 13924 ADDITION
 1ST STORY

DRAWN BY:	CHECKED BY:	DATE:	SCALE: 1/4"=1'-0"
REVISIONS:			DISK NO. CARBDA

01/14/02 0815

DO NOT SCALE THIS DRAWING. PHOTOCOPIES ARE NOT TO SCALE.

X

SN- /PD-?/X

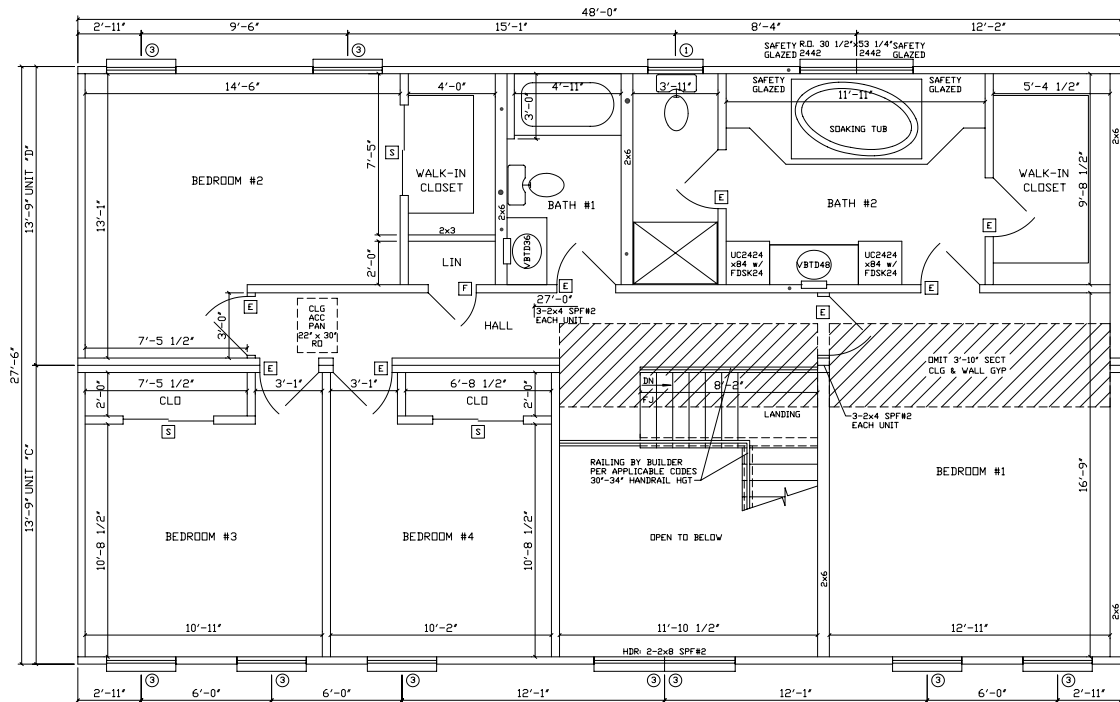

- NOTES:
- 2x4 SPF#2 EXT WALLS @ 16' O.C./2x4 MARR WALLS (EXCEPT AS NOTED)
 - 8'-0" CLG HT.
 - 2x10 SPF#2 FLDR JOISTS @ 16' O.C.
 - ROOF SYSTEM TO BE 2" D.C.
 - 7-D SINGLE HUNG WINDOWS (#1=24210, #2=2842, #3=304B, #4=2852, #11=2858C)
 - CLG BEAM OVER BR#1/HALL TO BE 2-1 1/2"x11 1/4"x29'-0" ML.

excel
Homes
 FROM THE INSIDE WWW.EXCELHOMES.COM

R.R.#2 BOX 683
 LIVERPOOL, PA 17045
 (717) 444-3395
 FAX (717) 444-7577

27⁶ 48 CARBONDALE
 2ND STORY

DRAWN BY:	CHECKED BY:	DATE:	SCALE: 1/4"=1'-0"
REVISIONS:			DISK NO. CARBDA

01/14/02 0815

DO NOT SCALE THIS DRAWING. PHOTOCOPIES ARE NOT TO SCALE.