

PLAN OPTION LEGEND:

NOTE: OPTIONS SHOWN ON PLAN AS DESCRIBED BELOW ARE NOT INCLUDED IN THE BASE PRICE.

- OPTION #1= OPTIONAL WASHER AND ELECTRIC DRYER HOOK-UP. SHELF INCLUDED WITH OR WITHOUT WASHER/DRYER HOOK-UP.
- OPTION #2= OPTIONAL PANELIZED GARAGE. WALLS TO BE BUILT AS PANELS, ROOF TRUSSES AND MATERIALS SHIPPED LOOSE. SADDLE MATERIALS SHIPPED LOOSE WHEN GARAGE ROOF JOINS MODULAR ROOF.
- OPTION #3= OPTIONAL PORCH ROOF MATERIALS SHIPPED LOOSE- PORCH FLOOR, COLUMNS AND RAILING BY OTHERS.
- OPTION #4= OPTIONAL S-LITE SIDELIGHTS - CS308W PER SIDE. STANDARD DOES NOT INCLUDE SIDELITES.
- OPTION #5= OPTIONAL GCS666F FIREPLACE, MANTLE, HEARTH, AND CHASE.
- OPTION #6= OPTIONAL DOUBLE BULL-NOSE.
- OPTION #7= OPTIONAL POCKET DOOR. STANDARD IS A 2/6 SWING DOOR.
- OPTION #8= OPTIONAL UNIVERSAL RUNDLE U-R 4650 PEDESTAL SINK SHOWN. STANDARD IS A 36" VANITY BASE (VBTD36).

STRUCTURAL NOTES:

- A) (2) 1 1/2" x 14" LAMINATED BEAMS ATTACHED TO CEILING FRAMING. TOP OF LAM BEAMS TO BE FLUSH WITH TOP OF STD. 2x12 PERIMETERS CREATING A DROPPED CEILING BEAM.
- B) (2) 1 1/2" x 11 1/4" LVL CEILING GIRDER PER MODULE. SEE NOTE "E" BELOW FOR BEAM SUPPORTING ROOF LOADING ABOVE.
- C) (2) 1 1/2" x 11 1/4" LVL CEILING GIRDER.
- D) (2) 1 1/2" x 16" LAMINATED BEAM HEADER.
- E) (1) 1 1/2" x 18" x 19" LVL CEILING GIRDER PER MODULE. START BEAM AT RIGHT SIDE OF MODULE.
- F) (1) 1 1/2" x 9 1/4" LVL CEILING GIRDER PER MODULE.
- G) (1) 1 1/2" x 16" LAM. BEAM IN CEILING. GIRDER TO CHAMFERED TO 10" MINIMUM AT INSIDE LINE OF BEARING POINT TO BE COVERED BY ROOF SHEATHING.
- H) (3) 1 1/2" x 7 1/4" LAMINATED BEAM HEADER.

STUD COLUMN LEGEND:

- (15) = (2) 2x4 STUD GRADE COLUMNS EACH MODULE
- (16) = (2) 2x6 STUD GRADE COLUMNS EACH MODULE
- (18) = (3) 2x4 STUD GRADE COLUMNS EACH MODULE
- (19) = (3) 2x6 STUD GRADE COLUMNS EACH MODULE

OPTIONS SHOWN ON PLANS AND ELEVATIONS ARE NOT IN THE *BASE PRICE*. OPTIONS TO BE SPECIFIED ON THE ACTUAL SALES ORDER FORM.

This Drawing is for REFERENCE ONLY and may be used in conjunction with STRUCTURAL DRAWINGS AND DETAILS. These prints are drawn as APPROXIMATE REPRESENTATIONS. Actual dimensions and overall appearance may differ due to construction techniques and conflicts that are beyond the control of AVIS AMERICA.

In Signing I Acknowledge I Have Received and Accept this print.

REVISIONS

Excel Homes
Building Excellence

7291EL EDGEVALE (TWO STORY)
1ST FLOOR

DRAWN BY: JPJ
CHECKED BY: JPD
DATE: 6/21/02
SCALE: 1/8"=1'-0"

SN- /PD-?/ STATE

BLDR/ CUST.

SHEET #

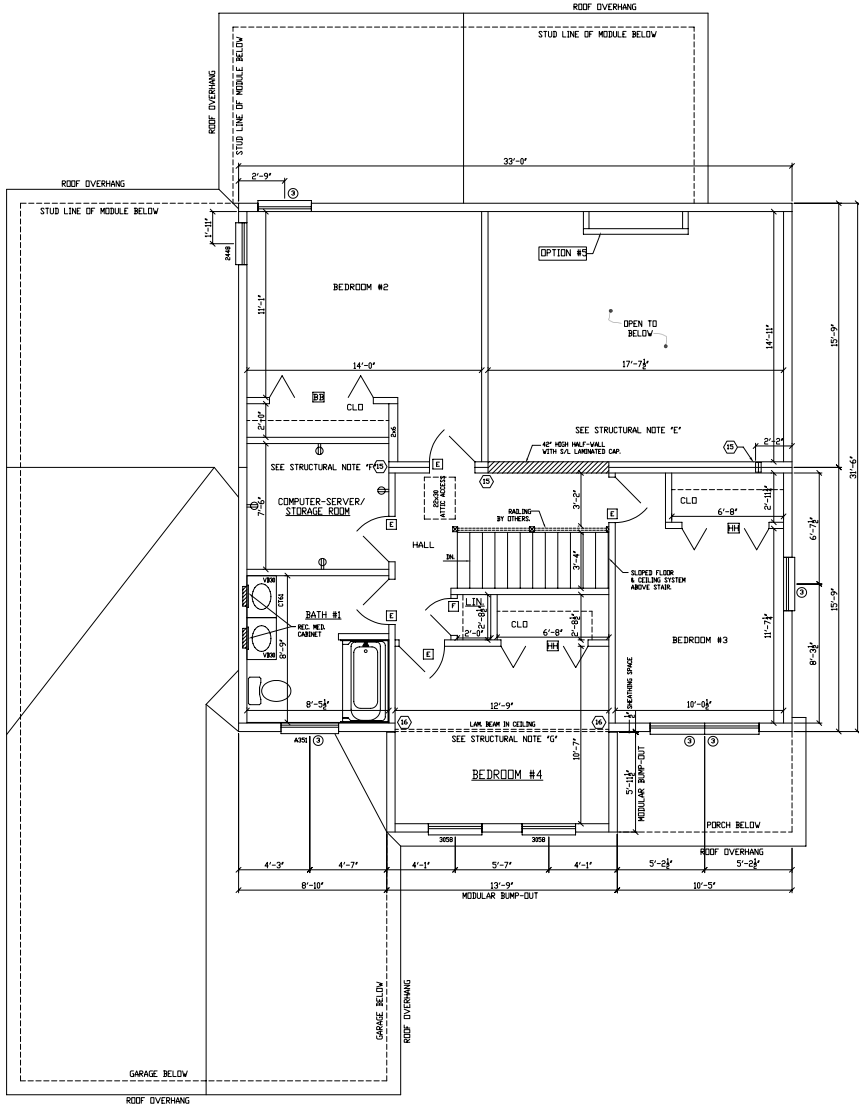

OPTIONS SHOWN ON PLANS AND ELEVATIONS ARE NOT IN THE "BASE PRICE". OPTIONS TO BE SPECIFIED ON THE ACTUAL SALES ORDER FORM.

SHEET #

7291EL EDGEVALE (TWO STORY)
2ND FLOOR

DRAWN BY: JPJ CHECKED BY: SN DATE: 6/21/02 SCALE: 1/8"=1'-0"

/PD-?/ STATE: BLDG/ CUST.

REVISIONS

Excel Homes
Building Excellence

This Drawing is for REFERENCE ONLY and may be used in conjunction with STRUCTURAL DRAWINGS AND DETAILS. These prints are drawn as APPROPRIATE REPRESENTATIONS. Actual dimensions and overall appearance may differ due to construction techniques and conflicts that are beyond the control of AVIS AMERICA.

In Signing I Acknowledge I Have Received and Accept this print: