

PLAN OPTION LEGEND:

- NOTE: OPTIONS SHOWN ON PLAN AS DESCRIBED BELOW ARE NOT INCLUDED IN THE BASE PRICE.
- OPTION #1 = OPTIONAL WASHER AND ELECTRIC DRYER HOOK-UP. SHELF INCLUDED WITH DR WITHOUT WASHER/DRYER HOOK-UP.
 - OPTION #2 = OPTIONAL PANELIZED GARAGE. WALLS TO BE BUILT AS PANELS, ROOF TRUSSES AND MATERIALS SHIPPED LOOSE. SADDLE MATERIALS SHIPPED LOOSE WHEN GARAGE ROOF JOINS MODULAR ROOF.
 - OPTION #3 = OPTIONAL PORCH ROOF MATERIALS SHIPPED LOOSE. PORCH FLOOR, COLUMNS AND RAILING BY OTHERS.
 - OPTION #4 = OPTIONAL GDC60F FIREPLACE, MANTEL, HEARTH, AND EXTERIOR CHASE.
 - OPTION #5 = OPTIONAL CS09V 15-LITE DOOR. CS210 6-PANEL DOOR IS STANDARD.
 - OPTION #6 = OPTIONAL MODULARIZED WALK-OUT BAY. WHEN BAY ROOF TERMINATES AT VERTICAL WALL (TWO-STORY) THE ROOF IS BUILT & SHIPPED ON THE BAY BY THE MANUFACTURER. WHEN THE ROOF ADJAINS AN ADJACENT ROOF (1-STORY), ROOF CONSTRUCTION MATERIALS ARE SHIPPED LOOSE. IF THE BAY OPTION IS NOT CHOSEN, THE CR16 WINDOWS ARE ELIMINATED AND THE DOOR SHOWN IS MOVED TO THE MODULAR WALL.
 - OPTION #7 = OPTIONAL WINDOW OVER GARAGE DOOR.
 - OPTION #8 = OPTIONAL MODULAR DORMER. SADDLE FROM DORMER TO MAIN ROOF COMPLETED BY OTHERS WITH SHIPPED LOOSE MATERIALS BY MANUFACTURER.
 - OPTION #9 = OPTIONAL 3-LITE OVER 1-PANEL SIDELIGHT - CS263. STANDARD DOES NOT INCLUDE A SIDELITE.
 - OPTION #10 = OPTIONAL SHIPPED LOOSE CLOSE-OFF PACKAGE.
 - OPTION #11 = OPTIONAL FLUE CHASE. WHEN CHASE IS NOT CHOSEN, THE CLOSETS SHALL BE MADE DEEPER.

STRUCTURAL NOTES:

- A) (2) 1 1/2" x 11 1/4" LAM. CEILING GIRDER - (1) ON MODULE AND (1) ON BUMP-OUT CEILING END OF BEAM TO BE CHAMFERED TO MEET BAY ROOF. BEAM DEPTH AT BEARING POINT TO BE 7 1/4" MIN.
- B) (1) 1 1/2" x 14" LAMINATED BEAM CEILING GIRDER PER MODULE.
- C) 2x10 SYP #2 HEADER PER MODULE.
- D) (3) 1 1/2" x 18" LAM. CEILING GIRDER - (1) ON MODULE AND (2) SHIPPED LOOSE FOR ON SITE INSTALLATION WITH GARAGE PACKAGE. BEAM ON MODULE TO BE MOUNTED FLUSH TOP OF BEAM WITH TOP OF CEILING JOIST.
- E) (1) 1 1/2" x 9 1/4" LAMINATED BEAM CEILING GIRDER.

STUD COLUMN LEGEND:

- (15) = (2) 2x4 STUD GRADE COLUMNS EACH MODULE.
- (16) = (2) 2x6 STUD GRADE COLUMNS EACH MODULE.
- (18) = (3) 2x4 STUD GRADE COLUMNS EACH MODULE.
- (19) = (3) 2x6 STUD GRADE COLUMNS EACH MODULE.

1640 SQ FT 7286 ECHO HILLS (RANCH)
 1ST FLOOR
 DRAWN BY: KNB CHECKED BY: AJH DATE: 6/10/02 SCALE: 1/8"=1'-0"
 SN- /PD-3/ STATE
 BL DR / CUST.

REVISIONS

1	
2	
3	
4	
5	
6	
7	

Excel Homes
Building Excellence

This drawing is for REFERENCE ONLY and may be used in conjunction with STRUCTURAL DRAWINGS AND DETAILS. These prints are to be drawn as APPROXIMATE REPRESENTATIONS. Actual dimensions and overall appearance may differ due to construction techniques and are beyond the control of AVIS AMERICA.
 In Signing I Acknowledge I Have Received and Accept this print

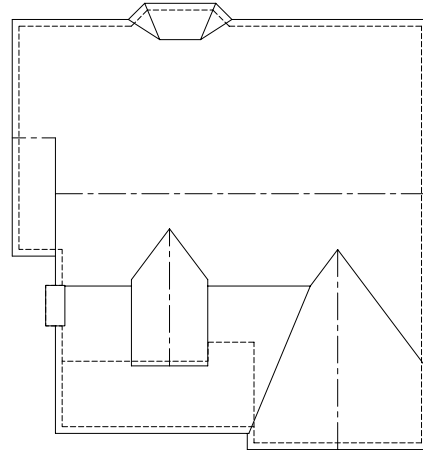
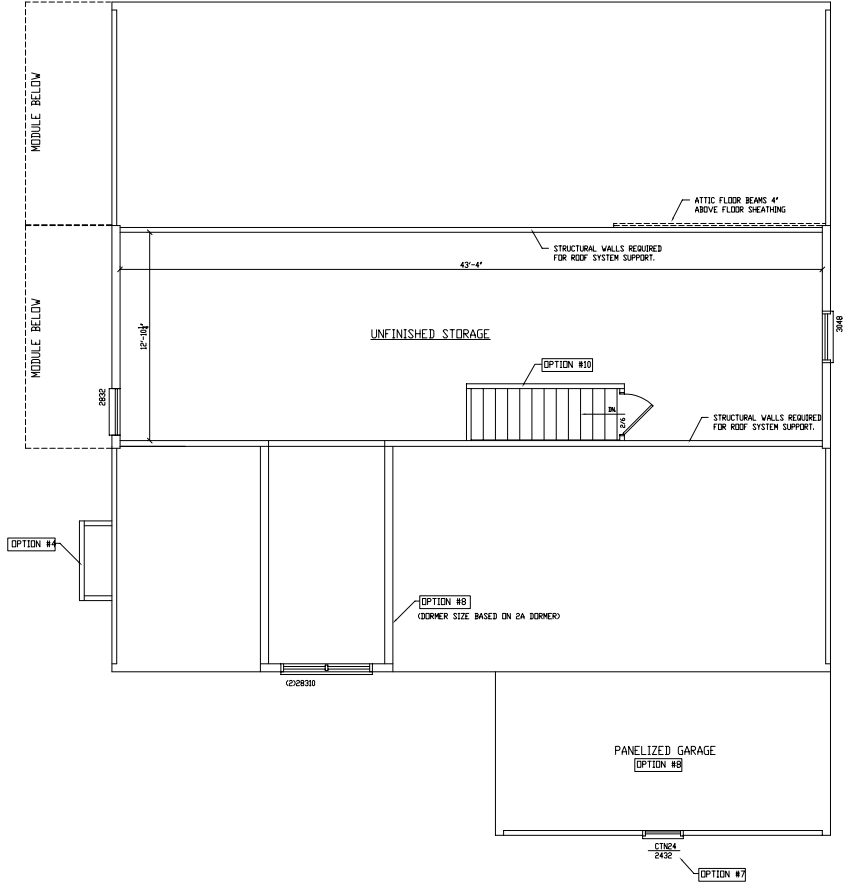

ROOF PLAN

1540 SQ. FT. 7286 ECHO HILLS (RANCH)
 2ND FLOOR
 DRAWN BY: KNB
 CHECKED BY: A.JH
 DATE: 6/10/02
 SCALE: 1/8"=1'-0"
 SN- /PJ-?/ STATE
 BLDR/ CUST.

Excel Homes
Building Excellence

REVISIONS

1.	
2.	
3.	
4.	
5.	
6.	
7.	

This drawing is for REFERENCE ONLY and may be used in conjunction with STRUCTURAL DRAWINGS AND DETAILS. These prints are drawn as APPROXIMATE REPRESENTATIONS. Actual dimensions and overall appearance may differ due to construction techniques and conflicts that are beyond the control of AVIS AMERICA.
 In Signing I Acknowledge I Have Received and Accept this print

SHEET #