

# ULTIMA T-10A TWO STORY

| WINDOWS       | EXT. DOORS         | INT. DOORS     | KIT. CABS.           |
|---------------|--------------------|----------------|----------------------|
| (9) - #3      | (1) - STD. 'A'     | (10) - PASSAGE | 17.25 FT - WALL CAB. |
| (2) - #1      | (1) - STD. 'B'     | (2) - SLIDER   | 17.5 FT - BASE CAB.  |
| (1) - #3 S.G. | (1) - VINYL SLIDER |                | 3 FT - DESKTOP AREA  |

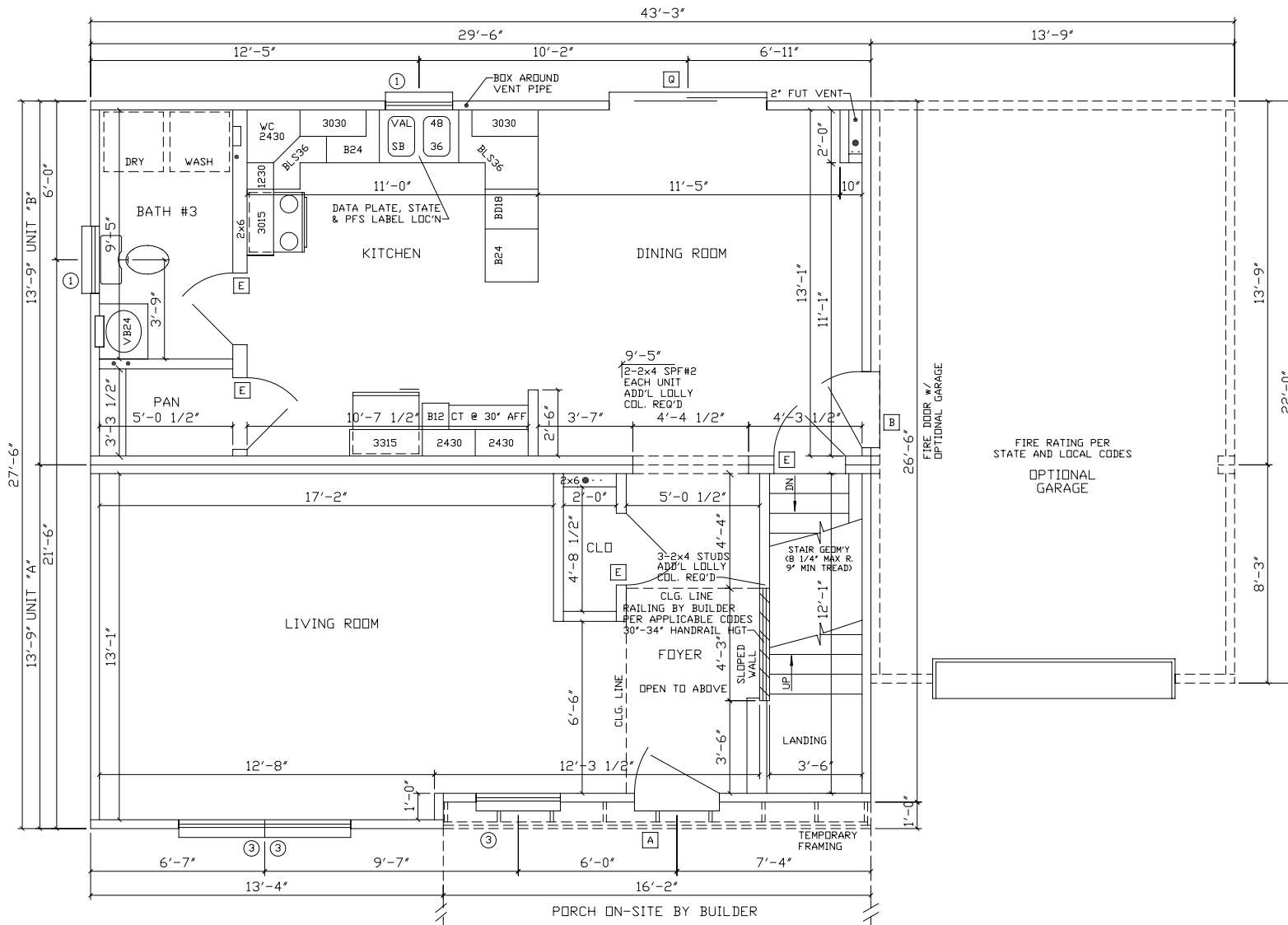

**NOTES:**

1. 2x4 SPF#2 EXT WALLS @ 16" O.C./2x4 MARR WALLS
2. 8'-0" CLG HT.
3. 2x10 SPF#2 FLOOR JOISTS @ 16" O.C.
4. 7-D SINGLE HUNG WINDOWS (#1=24210, #2=2842, #3=3048, #4=2852, #11=2558C)
5. CEILING DRYWALL WILL BE OMITTED FOR ALL ON-SITE PLUMBING CONNECTIONS



R.R.#2 BOX 683  
 LIVERPOOL, PA 17045  
 (717) 444-3395  
 FAX (717) 444-7577  
 WWW.EXCELHOMES.COM

27<sup>6</sup>29<sup>6</sup> ULTIMA T-10A  
 1ST STORY

|            |             |       |                      |
|------------|-------------|-------|----------------------|
| DRAWN BY:  | CHECKED BY: | DATE: | SCALE:<br>1/4"=1'-0" |
| REVISIONS: |             |       | DISK NO:<br>ULT-T10A |

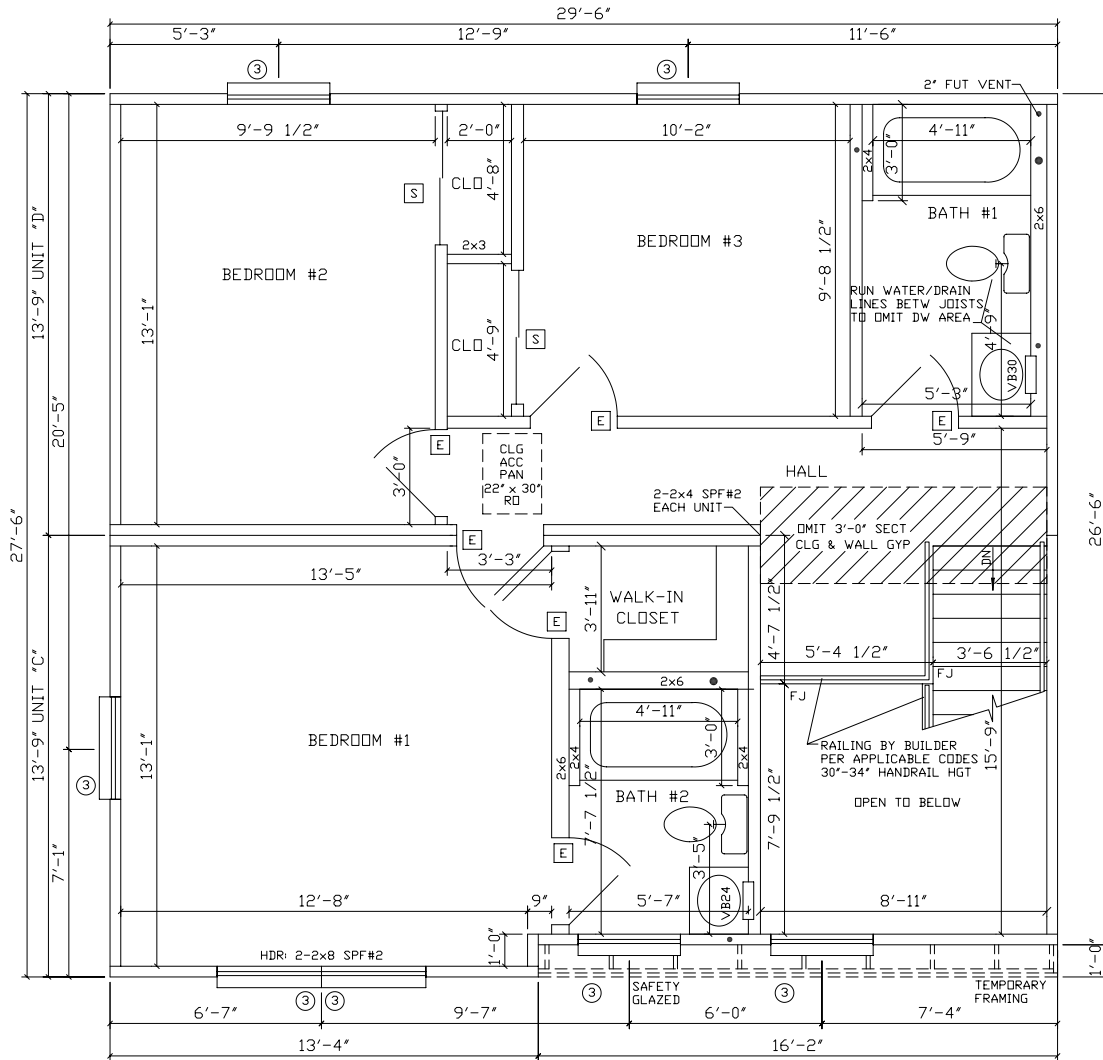

NOTES:

1. 2x4 SPF#2 EXT WALLS @ 16" O.C./2x4 MARR WALLS
2. 8'-0" CLG HT.
3. 2x10 SPF#2 FLOOR JOISTS @ 16" O.C.
4. ROOF SYSTEM TO BE 24" O.C.
5. 7-D SINGLE HUNG WINDOWS (#1=24210, #2=2842, #3=3048, #4=2852, #11=2558C)
6. CLG BEAM OVER HALL TO BE: 2-1 1/2"x9 1/4"x13'-0" M.L.



R.R.#2 BOX 683  
LIVERPOOL, PA 17045

(717) 444-3395

FAX (717) 444-7577

WWW.EXCELHOMES.COM

27<sup>6</sup>29<sup>6</sup> ULTIMA T-10A  
2ND STORY

|            |             |       |                      |
|------------|-------------|-------|----------------------|
| DRAWN BY:  | CHECKED BY: | DATE: | SCALE:<br>1/4"=1'-0" |
| REVISIONS: |             |       | DISK NO:<br>ULT-T10A |