

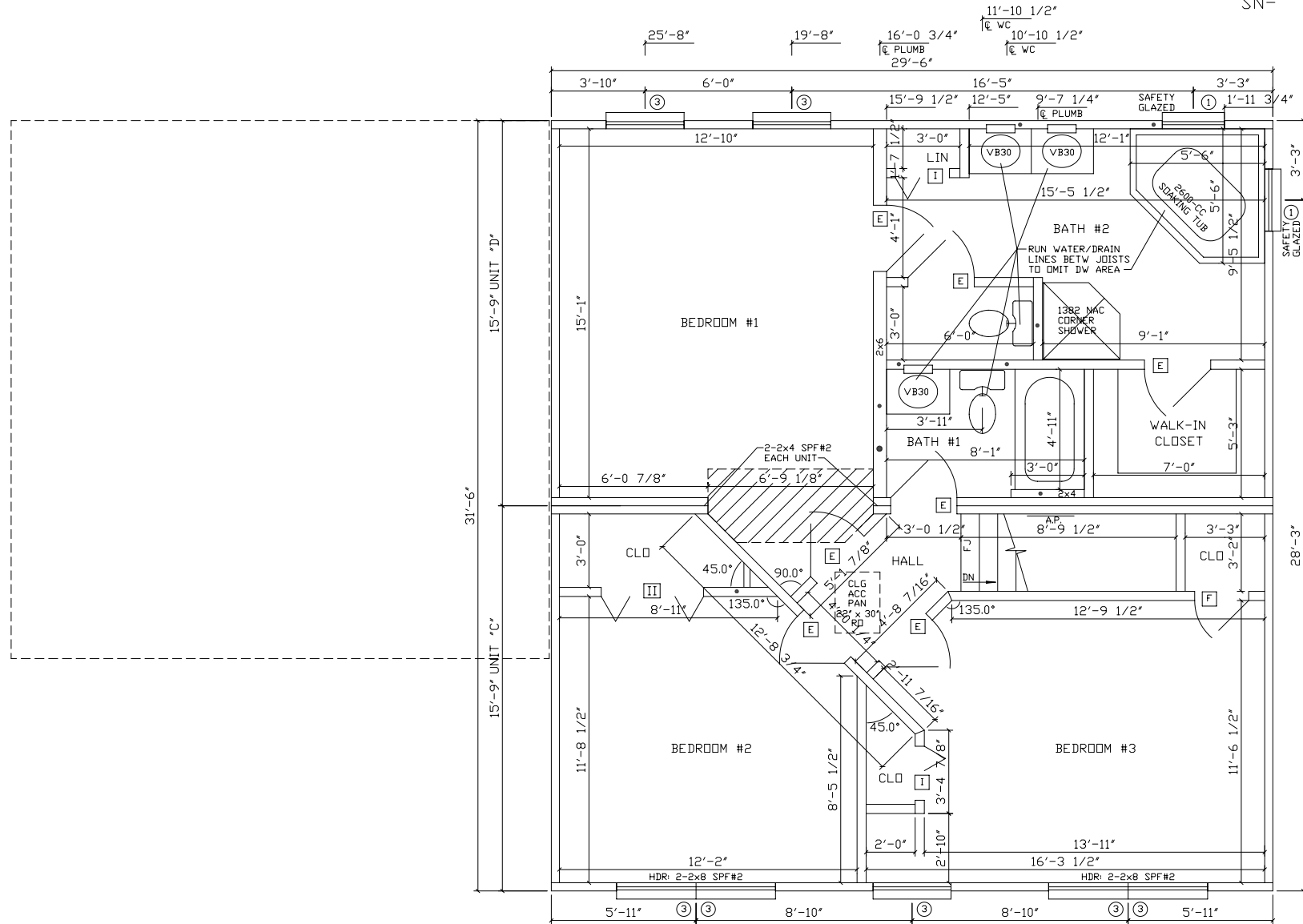

X

SN- /PD-?/X



NOTES:

- 1. 2x4 SPF#2 EXT WALLS @ 16" O.C./2x4 MARR WALLS
- 2. 8'-0" CLG HT.
- 3. 2x10 SPF#2 FLOOR JOISTS @ 16" O.C.
- 4. ROOF SYSTEM TO BE 24" O.C.
- 5. 7-D SINGLE HUNG WINDOWS (#1=24210, #2=2842, #3=3048, #4=2852, #11=2558C)
- 6. CLG BEAM OVER BR#1 TO BE 2'-2x10x17'-0" SYP#2

**excel**  
*Homes*  
 FROM THE INSIDE

R.R.#2 BOX 683  
 LIVERPOOL, PA 17045  
 (717) 444-3395  
 FAX (717) 444-7577  
 WWW.EXCELHOMES.COM

316 296 ULTIMA PLUS T1A  
 2ND STORY

DRAWN BY:	CHECKED BY:	DATE:	SCALE: 1/4"=1'-0"
REVISIONS:			DISK NO: ULT-T1A4
			01/14/02 08:25