

PATRIOT 1A

WINDOWS	EXT. DOORS	INT. DOORS	KIT. CAB.
(6) - #3	(1) - STD. 'A'	(8) - PASSAGE	13.5 FT. - WALL CAB.
(1) - #1	(2) - STD. 'B'		11.00 FT. - BASE CAB.

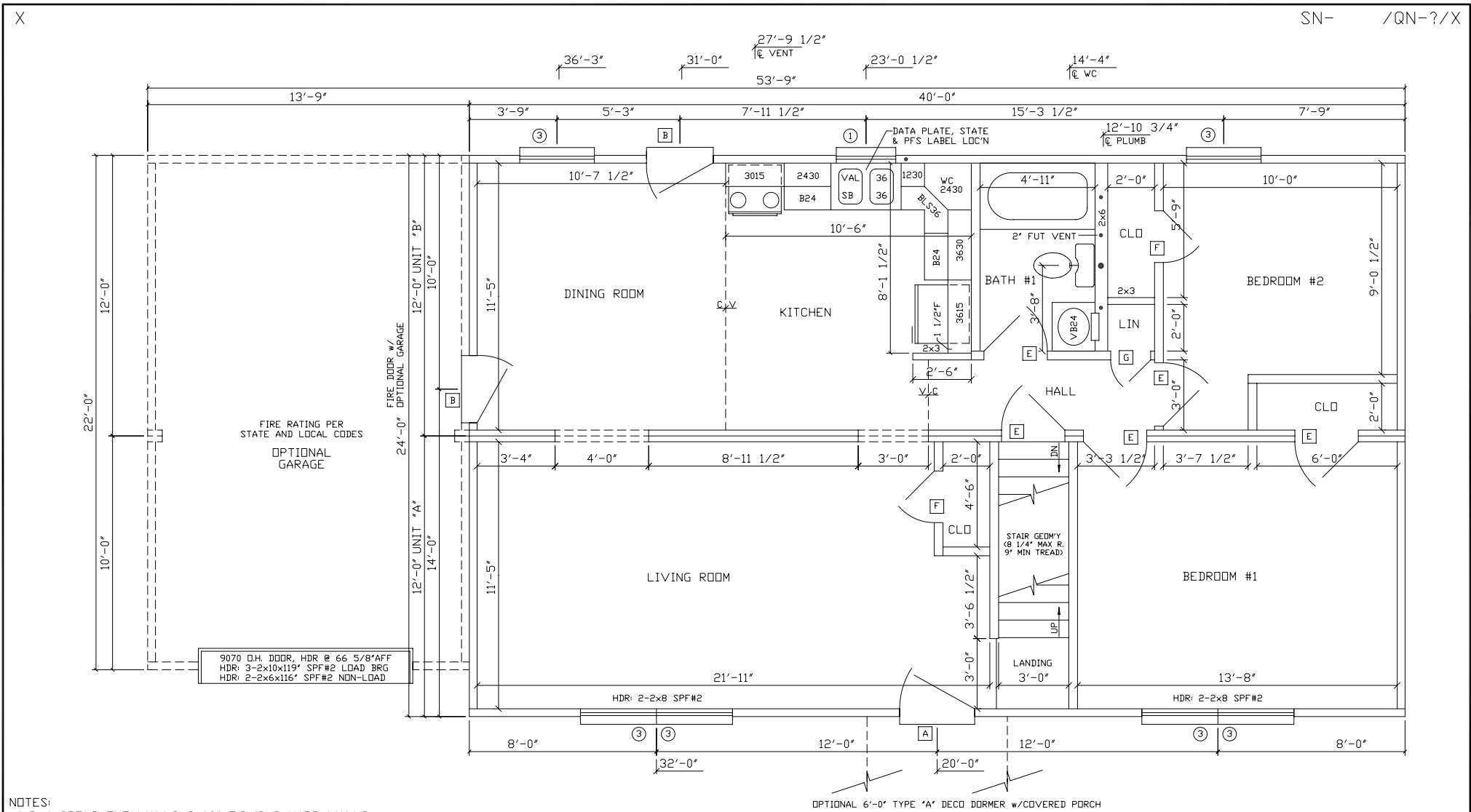

- NOTES:
- 1.2x4 SPF#2 EXT WALLS @ 16" O.C./2x3 MARR WALLS
 - 2.8'-0" CLG HT.
 - 3.2x8 SPF#2 FLOOR JOISTS @ 16" O.C.(JOIST HANGERS REQ'D FOR N.Y.S.)
 - 4.ROOF SYSTEM TO BE 16" O.C.
 - 5.7'-D SINGLE HUNG WINDOWS (1=24210, #2=2842, #3=3048, #4=2852, #11=2558C)

excel
Homes
 FROM THE INSIDE

R.R.#2 BOX 683
 LIVERPOOL, PA 17045
 (717) 444-3395
 FAX (717) 444-7577
 WWW.EXCELHOMES.COM

2440 PATRIOT 1A			
DRAWN BY:	CHECKED BY:	DATE:	SCALE: 1/4"=1'-0"
REVISIONS: REV. STD 10-29-01		DISK NO: PAT1A	
01/14/02 08:23			